



COPPER NICKEL FLANGES

bulkhead pieces - DIN 86068 in copper nickel and carbon steel

fittings

STANDARD : DIN 86 068

Printable version

PDF version

fittings

Outside diameter of pipe ØD		E mm	ØA mm	L mm	L1 mm	Ød1 mm	Ød2 mm	e mm	Theo. weight Kg/piece
nominal inch	actual mm								
0.75	25	8	100	120	60	25	27	1.5	0.7
1	30	8	110	120	60	30	33	1.5	0.92
1.25	38	8	120	140	70	38	40	1.5	1.09
1.5	44.5	10	130	130	65	44.5	46.5	1.5	1.46
2	57	10	143	140	70	57	59	1.5	1.74
2.5	76.1	10	162	150	65	76.1	78.1	2	2.36
3	88.9	12	179	160	80	88.9	91	2	3.2
4	108	12	198	160	80	108	110	2.5	3.95
5	133	12	223	160	80	133	135.5	2.5	4.85
6	159	16	257	170	85	159	161.5	2.5	7.37
7	193.7	16	292	180	90	193.7	197	3	9.23
8	219.1	16	317	180	90	219.1	222	3	10.67
10	267	16	365	200	100	267	270	3	13.44
12	323.9	16	422	220	110	323.9	327	4	18.97
14	368	16	482	240	120	368	371	4	25.23
16	419.1	18	540	260	130	419.1	422	4	30.83
18	457.2	18	590	260	130	457	460	4	35.4
20	508	18	646	260	130	508	511	4.5	41.74
24	610	18	755	260	130	610	613	4.5	51



COPPER NICKEL FLANGES

bulkhead pieces - DIN 86068 in copper nickel and carbon steel
pieces type A

Printable version
PDF version

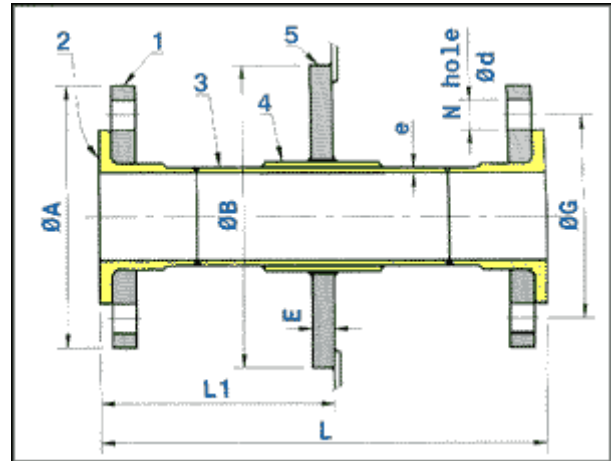

Outside diameter of pipe ØD		PN	E	ØB	L1	ØA	L	e	Drilling			Theo. weight Kg/piece
nominal inch	actual mm								ØG	N bolt holes	Ød	
0.75	25	16	14	150	100	105	200	2	75	4	14	4.1
1	30	16	14	160	100	115	200	2	85	4	14	5.1
1.25	38	16	14	185	110	140	220	2	100	4	18	7.1
1.5	44.5	16	14	205	110	150	220	2	110	4	18	8.5
2	57	16	14	220	115	165	230	2	125	4	18	10
2.5	76.1	16	14	240	120	185	240	3	145	4	18	12.5
3	88.9	16	14	255	130	200	260	2.5	160	8	18	15.1
4	108	16	14	275	130	220	260	3	180	8	18	17.6
5	133	16	16	305	130	250	260	3.5	210	8	18	22.7
6	159	16	16	340	135	285	270	3.5	240	8	22	29.1
7	193.7	16	16	370	140	315	280	4	270	8	22	36.3
8	219.1	10	16	395	140	340	280	4	295	8	22	38.7
10	267	10	16	460	150	395	300	5	350	12	22	53.6
12	323.9	10	20	525	160	445	320	5	400	12	22	71.6
14	368	10	20	585	170	505	340	6	460	16	22	91.6
16	419.1	10	20	645	180	565	360	8	515	16	26	120.4



COPPER NICKEL FLANGES

bulkhead pieces - DIN 86068 in copper nickel and carbon steel

pieces type B - 10 bar - DIN 86068

STANDARD : DIN 86 068 NP 10

Printable version

PDF version

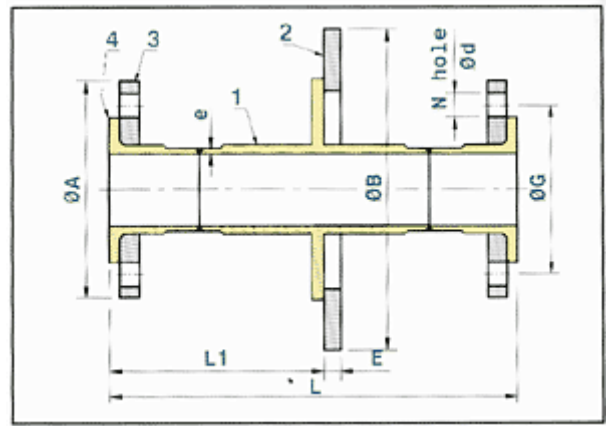

Outside diameter of pipe ØD		E	ØB	L1	ØA	L	e	Drilling			Theo. weight Kg/piece
nominal inch	actual mm							ØG	N bolt holes	Ød	
0.75	25	14	151	100	105	200	2	75	4	14	4.05
1	30	14	160	100	115	200	2	85	4	14	5.2
1.25	38	14	185	110	140	220	2	100	4	18	7.15
1.5	44.5	14	205	110	150	220	2	110	4	18	8.75
2	57	14	220	115	165	230	2	125	4	18	10.25
2.5	76.1	14	240	120	185	240	3	145	4	18	12.45
3	88.9	14	255	130	200	260	2.5	160	8	18	15.5
4	108	14	275	130	220	260	3	180	8	18	17.9
5	133	16	305	130	250	260	3.5	210	8	18	22.8
6	159	16	340	135	285	270	3.5	240	8	22	29.7
7	193.7	16	370	140	315	280	4	270	8	22	34.1
8	219.1	22	395	140	340	280	3	295	8	22	39.3
10	267	22	460	150	395	300	4	350	12	22	51.85
12	323.9	22	525	160	445	320	4	400	12	22	72.9
14	368	22	585	170	505	340	5	460	16	22	95.45
16	419.1	26	645	180	565	360	5	515	16	26	119.8



COPPER NICKEL FLANGES

bulkhead pieces - DIN 86068 in copper nickel and carbon steel

pieces type B - 16 bar - DIN 86069

STANDARD : DIN 86 069 NP 16

Printable version

PDF version

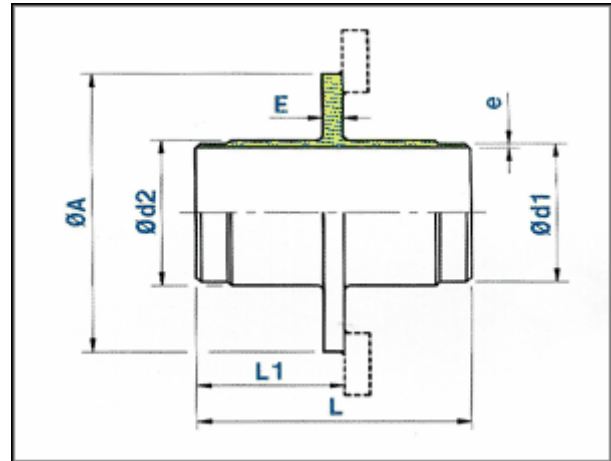

Outside diameter of pipe ØD		E	ØB	L1	ØA	L	e	Drilling			Theo. weight Kg/piece
nominal inch	actual mm							ØG	N bolt holes	Ød	
0.75	25	14	151	100	105	200	2	75	4	14	4.05
1	30	14	160	100	115	200	2	85	4	14	5.2
1.25	38	14	185	110	140	220	2	100	4	18	7.15
1.5	44.5	14	205	110	150	220	2	110	4	18	8.75
2	57	14	220	115	165	230	2	125	4	18	10.25
2.5	76.1	14	240	120	185	240	3	145	4	18	12.45
3	88.9	14	255	130	200	260	2.5	160	8	18	15.5
4	108	14	275	130	220	260	3	180	8	18	17.9
5	133	16	305	130	250	260	3.5	210	8	18	22.8
6	159	16	340	135	285	270	3.5	240	8	22	29.7
7	193.7	16	370	140	315	280	4	270	8	22	34.1
8	219.1	16	395	140	340	280	4	295	12	22	40.4
10	267	16	460	150	405	300	5	355	12	26	55.25
12	323.9	20	525	160	460	320	6	410	12	26	77.1
14	368	20	585	170	520	340	6	470	16	26	105.3
16	419.1	20	645	180	580	360	8	525	16	30	131.6



COPPER NICKEL FLANGES

composite blind flange - ISO NP10 / ANSI B16.5 in carbon steel with copper nickel disc galvanized or epoxy coated

composite blind flange - 10 bar - ISO NP10 in carbon steel with copper nickel disc galvanized or epoxy coated

STANDARD : ISO NP 10

Printable version

PDF version

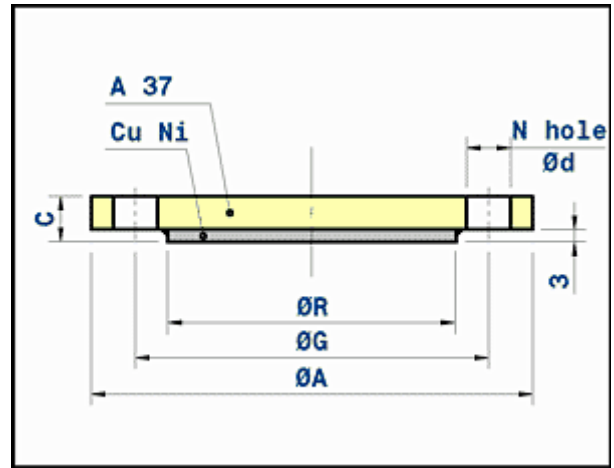

Outside diameter of pipe ØD		ØA mm	C mm	ØR mm	Drilling			Theo. weight Kg/piece
nominal inch	actual mm				ØG mm	N bolt holes	Ød mm	
0.5	20	95	14	46	65	4	14	0.78
0.75	25	105	16	56	75	4	14	1.15
1	30	115	16	65	85	4	14	1.40
1.25	38	140	18	76	100	4	18	2.00
1.5	44.5	150	18	84	110	4	18	2.35
2	57	165	20	99	125	4	18	3.20
2.5	76.1	185	20	118	145	4	18	4.15
3	88.9	200	20	132	160	8	18	5.70
4	108	220	22	156	180	8	18	7.05
5	133	250	22	184	210	8	18	10.05
6	159	285	24	211	240	8	22	13.00
7	193.7	315	24	242	270	8	22	18.00
8	219.1	340	24	266	295	8	22	20.80
10	267	395	26	319	350	12	22	29.65
12	323.9	445	26	370	400	12	22	38.70
14	368	505	26	429	460	16	22	53.55
16	419.1	565	28	480	515	16	26	69.45
18	457.2	615	28	530	565	20	26	82.40
20	508	670	30	582	620	20	26	104.70
24	610	780	34	682	725	20	30	149.75



COPPER NICKEL FLANGES

composite blind flange - ISO NP10 / ANSI B16.5 in carbon steel with copper nickel disc galvanized or epoxy coated

composite blind flange - 150 lbs - ANSI B16.5 in carbon steel with copper nickel disc galvanized or epoxy coated

STANDARD : ANSI B 16.5

Printable version
PDF version

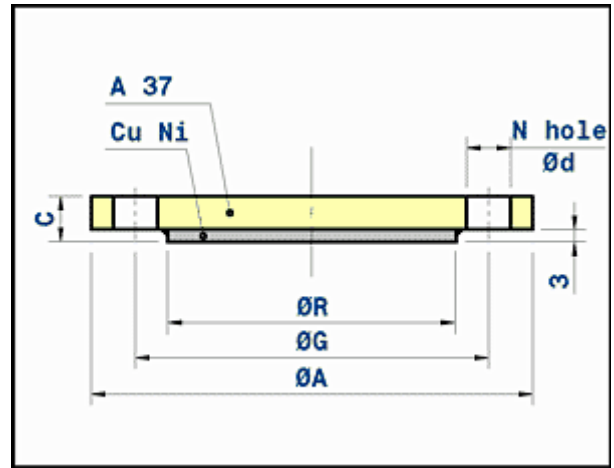

Outside diameter of pipe ØD		ØA mm	C mm	ØR mm	Drilling			Theo. weight Kg/piece
nominal inch	actual mm				ØG mm	N bolt holes	Ød mm	
0.5	20	88.9	12.5	34.9	60.3	4	15.9	0.80
0.75	25	98.4	14.1	42.9	69.8	4	15.9	0.90
1	30	108.0	15.7	50.8	79.4	4	15.9	1.00
1.25	38	117.5	17.3	63.5	88.9	4	15.9	1.30
1.5	44.5	127.0	18.9	73.0	98.4	4	15.9	1.40
2	57	152.4	20.5	92.1	120.6	4	19	1.80
2.5	76.1	177.8	23.6	104.8	139.7	4	19	3.20
3	88.9	190.5	25.2	127.0	152.4	4	19	4.00
4	108	228.6	25.2	157.2	190.5	8	19	8.00
5	133	254.0	25.2	185.7	215.9	8	22.2	9.00
6	159	279.4	26.8	215.9	241.3	8	22.2	12.00
8	219.1	342.9	30.0	269.9	298.4	8	22.2	20.00
10	267	406.4	31.6	323.8	361.9	12	25.4	32.00
12	323.9	482.6	33.2	381.0	431.8	12	25.4	50.00
14	368	533.4	36.3	425.1	476.2	12	28.6	59.00
16	419.1	596.9	37.9	482.6	539.7	16	28.6	77.00
18	457.2	635.0	41.1	533.4	577.8	16	31.7	95.00
20	508	698.5	44.3	584.2	635.0	20	31.7	123.00
24	610	812.8	49.0	692.1	749.3	20	34.9	186.00



COPPER NICKEL FLANGES

composite blind flange - ISO NP10 / ANSI B16.5 in carbon steel with copper nickel disc galvanized or epoxy coated

composite blind flange - 300 lbs - ANSI B16.5 in carbon steel with copper nickel disc galvanized or epoxy coated

STANDARD : ANSI B 16.5

Printable version
PDF version

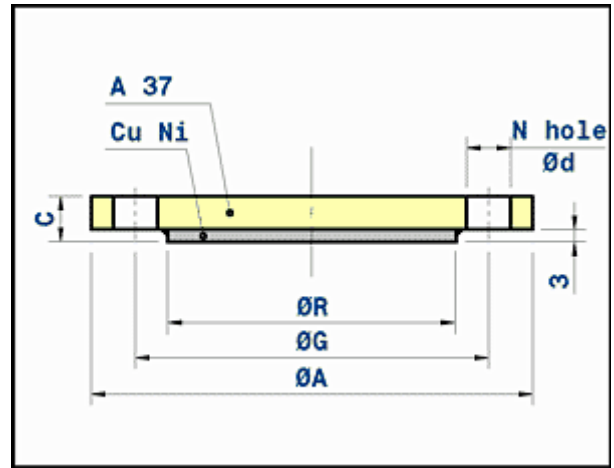

Outside diameter of pipe ØD		ØA mm	C mm	ØR mm	Drilling			Theo. weight Kg/piece
nominal inch	actual mm				ØG mm	N bolt holes	Ød mm	
0.5	20	95.2	15.6	34.9	66.7	4	15.9	1.00
0.75	25	117.5	17.3	42.9	82.5	4	19	1.50
1	30	123.8	18.9	50.8	88.9	4	19	2.00
1.25	38	133.3	20.4	63.5	98.4	4	19	2.50
1.5	44.5	155.6	22.0	73.0	114.3	4	22.2	3.00
2	57	165.1	23.6	92.1	127.0	8	19	3.50
2.5	76.1	190.5	26.8	104.8	149.2	8	22.2	5.50
3	88.9	209.5	30.0	127.0	168.3	8	22.2	7.00
4	108	254.0	33.2	157.2	200.0	8	22.2	12.00
5	133	279.4	36.3	185.7	234.9	8	22.2	16.00
6	159	317.5	37.9	215.9	269.9	12	22.2	23.00
8	219.1	381.0	42.7	269.9	330.2	12	25.4	36.50
10	267	444.5	49.0	323.8	387.3	16	28.6	57.50
12	323.9	520.7	52.2	381.0	450.8	16	31.7	83.00
14	368	584.2	55.4	425.1	514.3	20	31.7	107.00
16	419.1	647.7	58.6	482.6	571.5	20	34.9	139.00
18	457.2	711.2	61.7	533.4	628.6	24	34.9	177.00
20	508	774.7	64.9	584.2	685.8	24	34.9	223.00
24	610	914.4	71.2	692.1	812.8	24	41.3	342.00



COPPER NICKEL FLANGES

composite slip on flange - DIN 86036 / EEMUA 145
/ ISO in copper nickel and carbon steel

inner flange - 10 bar - DIN 86036 in copper nickel

STANDARD : DIN 86036

Printable version
PDF version

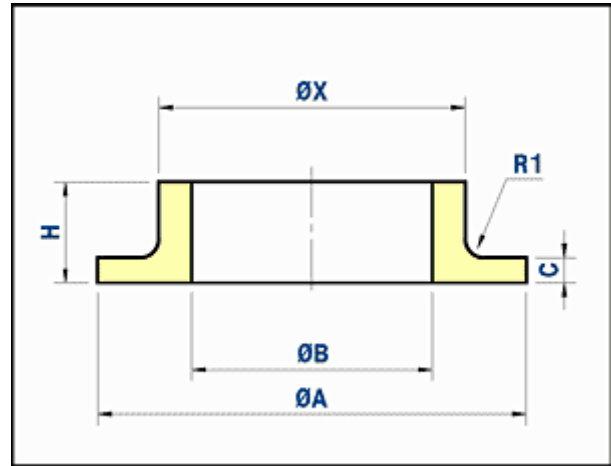

Outside diameter of pipe ØD		ØA mm	H mm	C mm	ØX mm	ØB mm	R1 mm	Theo. weight Kg/piece
nominal inch	actual mm							
0.5	20	45	22	6	31	20.20	2	0.13
0.75	25	58	22	6	37	25.20	2	0.19
1	30	68	24	6	44	30.20	2	0.28
1.25	38	78	24	6	54	38.25	2	0.37
1.5	44.5	88	24	6	60	44.75	2	0.43
2	57	102	24	6	73	57.30	2	0.54
2.5	76.1	122	24	6	90	76.30	2	0.65
3	88.9	138	26	6	106	89.40	2	0.89
4	108	158	26	6	126	108.40	2	1.10



COPPER NICKEL FLANGES

composite slip on flange - DIN 86036 / EEMUA 145
/ ISO in copper nickel and carbon steel

inner flange - 16&20 bar - EEMUA 145 in copper nickel

STANDARD : EEMUA Pub. N°145

Printable version

PDF version

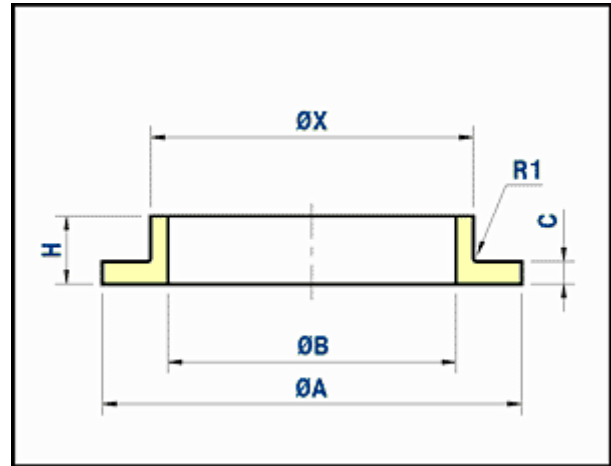

Outside diameter of pipe ØD		ØA mm	H mm	C mm	ØX mm	ØB mm	R1 mm	Theo. weight Kg/piece
nominal inch	actual mm							
0.5	16	40	16	5	21	16.07	1	0.06
0.75	25	53	16	5	31	25.08	1	0.10
1	30	60	18	5	36	30.08	1	0.14
1.25	38	70	18	5	45	38.10	1	0.20
1.5	44.5	80	19	5	51	44.60	1	0.30
2	57	99	19	6	67	57.23	1	0.40
2.5	76.1	120	19	6	87	76.33	1	0.50
3	88.9	130	21	7	100	89.18	1	0.70
4	108	158	23	7	120	108.38	1	0.90



COPPER NICKEL FLANGES

composite slip on flange - DIN 86036 / EEMUA 145
/ ISO in copper nickel and carbon steel

outer flange - 10 bar - ISO NP10 in carbon steel -
galvanized or epoxy coated

STANDARD : ISO NP 10

Printable version
PDF version

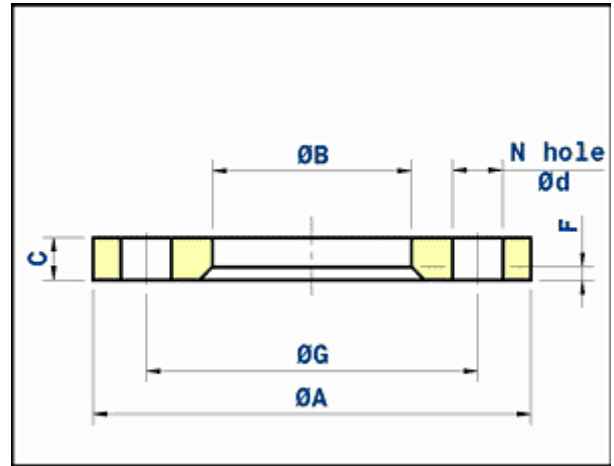

Outside diameter of pipe ØD		ØA	C	ØB	F	Drilling			Theo. weight Kg/piece
nominal inch	actual mm					ØG	N bolt holes	Ød	
0.5	20	95	14	32	2	65	4	14	0.65
0.75	25	105	14	38	2	75	4	14	0.75
1	30	115	16	45	2	85	4	14	1.01
1.25	38	140	16	55	2	100	4	18	1.50
1.5	44.5	150	16	62	2	110	4	18	1.71
2	57	165	16	75	2	125	4	18	2.00
2.5	76.1	185	16	92	2	145	4	18	2.41
3	88.9	200	18	108	2	160	4	18	3.00
4	108	220	18	128	2	180	8	18	3.26



COPPER NICKEL FLANGES

composite slip on flange - DIN 86036 / EEMUA 145
/ ISO in copper nickel and carbon steel

outer flange - 16&20 bar - EEMUA 145 in carbon steel
- galvanized or epoxy coated

STANDARD : EEMUA Pub. N°145

Printable version
PDF version

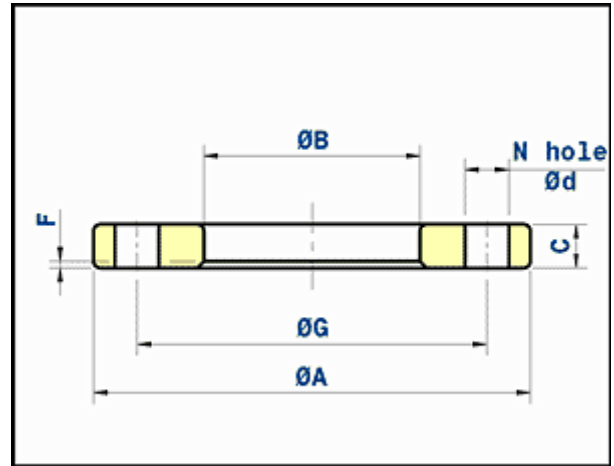

Outside diameter of pipe ØD		ØA mm	C mm	ØB mm	F mm	Drilling			Theo. weight Kg/piece
nominal inch	actual mm					ØG mm	N bolt holes	Ød mm	
0.5	16	89	14	23	3	60.3	4	15.9	0.75
0.75	25	98	14	33	3	69.8	4	15.9	0.80
1	30	108	14	38	3	79.4	4	15.9	0.95
1.25	38	117	14	47	3	88.9	4	15.9	1.10
1.5	44.5	127	14	53	3	98.4	4	15.9	1.15
2	57	152	18	69	3	120.6	4	19	2.10
2.5	76.1	178	18	89	3	139.7	4	19	2.60
3	88.9	190	19	103	3	152.4	4	19	2.90
4	108	229	24	123	3	190.5	4	19	5.90



COPPER NICKEL FLANGES

composite weld neck - inner flange - DIN 86037 /
EEMUA 145 in copper nickel

inner flange - 10 bar - DIN 86037

STANDARD : DIN 86037

Printable version
PDF version

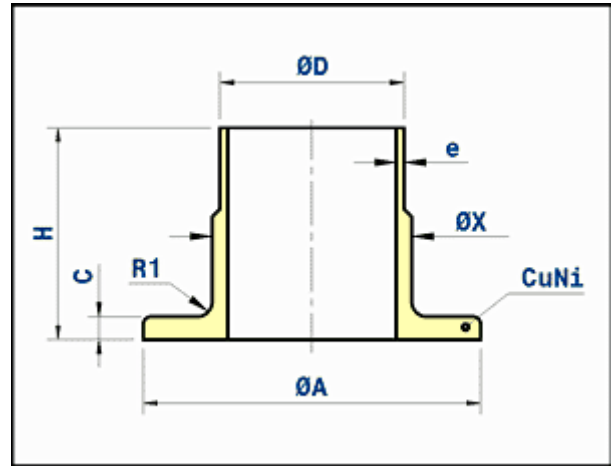

Outside diameter of pipe ØD		Wall thickness e	ØA	H	C	ØX	R1	Theo. weight Kg/piece
nominal inch	actual mm							
0.75	25	1.5	58	40	5	27	3	0.17
1	30	1.5	68	40	5	32	4	0.24
1.25	38	1.5	78	40	5	40	4	0.26
1.5	44.5	1.5	88	45	6	46.5	4	0.42
2	57	1.5	102	45	6	59	5	0.53
2.5	76.1	2	122	45	6	78	5	0.64
3	88.9	2	138	50	7	91	5	0.86
4	108	2.5	158	50	7	110	5	1.10
5	133	2.5	188	50	7	135.5	5	1.50
6	159	2.5	212	50	9	161.5	5	2.00
7	193.7	2.5	242	50	9	197	5	2.30
8	219.1	3	268	50	9	222	5	2.70
10	267	3	320	50	9	270	5	3.40
12	323.9	4	370	50	11	327	7	4.60
14	368	4	430	50	11	371	7	6.20
16	419.1	4	482	50	12	422	7	7.50
18	457.2	4	530	50	12	460	7	9.00
20	508	4.5	585	50	12	511	7	10.65
24	610	5	685	60	14	613	9	14.90



COPPER NICKEL FLANGES

composite weld neck - inner flange - DIN 86037 /
EEMUA 145 in copper nickel

inner flange - 14 bar - DIN 86037

STANDARD : DIN 86037

Printable version
PDF version

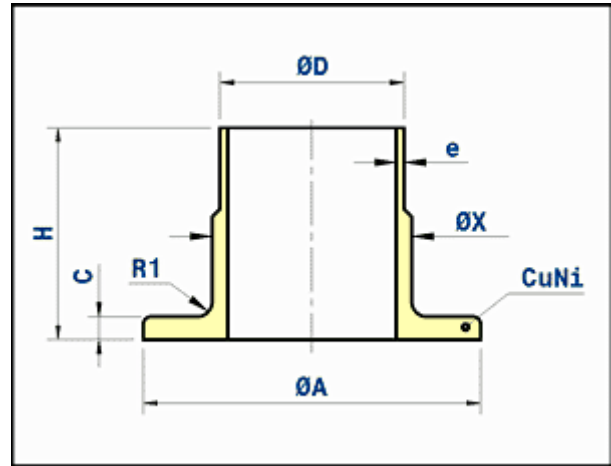

Outside diameter of pipe ØD		Wall thickness e mm	ØA mm	H mm	C mm	ØX mm	R1 mm	Theo. weight Kg/piece
nominal inch	actual mm							
3	88.9	2.5	138	50	7	91	5	0.90
5	133	3	188	50	7	135.5	5	1.55
6	159	3	212	50	9	161.5	5	2.10
7	193.7	3.5	242	50	9	197	5	2.55
8	219.1	3.5	268	50	9	222	5	2.90
10	267	4	320	50	9	270	5	3.80
12	323.9	5	370	50	11	327	7	5.40
14	368	5.5	430	50	11	371	7	6.95
16	419.1	6	482	50	12	422	7	8.65
18	457.2	6	530	50	12	460	7	10.15
20	508	6.5	585	50	12	511	7	11.90
24	610	8	685	60	14	613	9	17.65



COPPER NICKEL FLANGES

composite weld neck - inner flange - DIN 86037 /
EEMUA 145 in copper nickel

long inner flange - 16 bar - EEMUA 145

STANDARD : EEMUA Pub. N°145

Printable version
PDF version

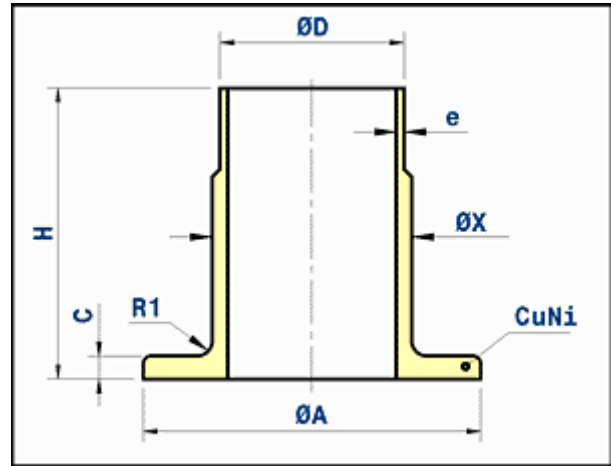

Outside diameter of pipe ØD		Wall thickness e mm	ØA mm	H mm	C mm	ØX mm	R1 mm	Theo. weight Kg/piece
nominal inch	actual mm							
0.5	16	2	40	51	4	18	2	0.09
0.75	25	2	50	51	5	27	3	0.19
1	30	2.5	60	51	5	32	4	0.23
1.25	38	2.5	70	51	5	40	4	0.29
1.5	44.5	2.5	80	51	6	46.5	4	0.44
2	57	2.5	99	64	6	59	5	0.61
2.5	76.1	2.5	120	64	6	78	5	0.80
3	88.9	2.5	130	64	7	91	5	0.97
4	108	3	158	76	7	110	5	1.50
6	159	3	212	89	9	161.5	5	2.90
8	219.1	4	270	102	9	222	5	5.10
10	267	4.5	320	127	9	270	5	8.90
12	323.9	5.5	370	152	11	327	7	13.80
14	368	6.5	430	152	11	371	7	16.60
16	419.1	7	482	152	12	422	7	20.25
18	457.2	8	530	152	12	460	7	23.60
20	508	8.5	585	152	12	511	7	28.65
24	610	10.5	685	152	14	613	9	39.25
28	711	12	800	190	19	719	9	75.30
32	813	13.5	905	190	20.5	827	9	94.60
36	914	15.5	1000	190	22	922	9	115.55



COPPER NICKEL FLANGES

composite weld neck - inner flange - DIN 86037 /
EEMUA 145 in copper nickel

long inner flange - 20 bar - EEMUA 145

STANDARD : EEMUA Pub. N°145

Printable version
PDF version

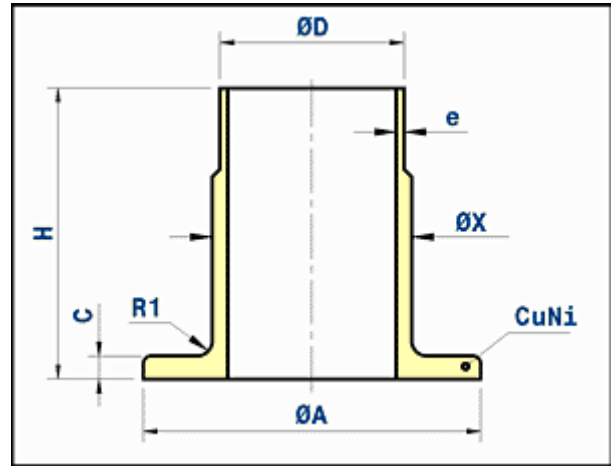

Outside diameter of pipe ØD		Wall thickness e mm	ØA mm	H mm	C mm	ØX mm	R1 mm	Theo. weight Kg/piece
nominal inch	actual mm							
0.5	16	2	40	51	4	18	2	0.09
0.75	25	2	50	51	5	27	3	0.19
1	30	2.5	60	51	5	32	4	0.23
1.25	38	2.5	70	51	5	40	4	0.29
1.5	44.5	2.5	80	51	6	46.5	4	0.44
2	57	2.5	99	64	6	59	5	0.61
2.5	76.1	2.5	120	64	6	78	5	0.80
3	88.9	2.5	130	64	7	91	5	0.97
4	108	3	158	76	7	110	5	1.50
6	159	3.5	212	89	9	161.5	5	2.90
8	219.1	4.5	270	102	9	222	5	5.20
10	267	5.5	320	127	9	270	5	9.80
12	323.9	7	370	152	11	327	7	15.40
14	368	8	430	152	11	371	7	19.00
16	419.1	9	482	152	12	422	7	23.95
18	457.2	9.5	530	152	12	460	7	26.40
20	508	11	585	152	12	511	7	33.85
24	610	13	685	152	14	613	9	45.50
28	711	15	800	190	19	719	9	86.20
32	813	17	905	190	20.5	821	9	100.15
36	914	19	1000	190	22	922	9	131.95



COPPER NICKEL FLANGES

composite weld neck flange - outer flange - DIN 86037 / EEMUA 145 / ANSI B16.5 in carbon steel A37 or A105

outer flange - 10 bar - DIN 86037 - galvanized or epoxy coated

STANDARD : ISO NP10 - DIN 86037

Printable version
PDF version

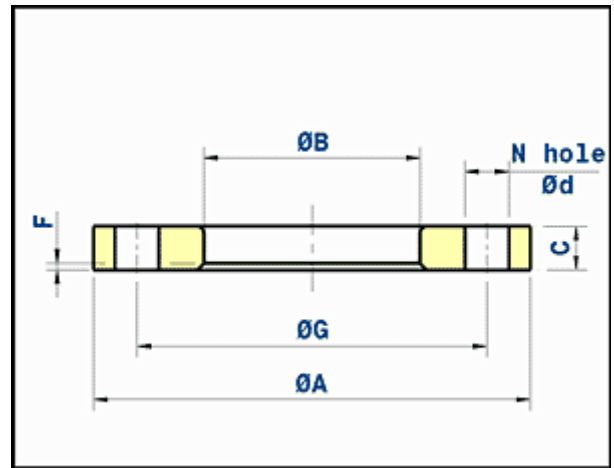

Outside diameter of pipe ØD		ØA	C	ØB	F	Drilling			Theo. weight Kg/piece
nominal inch	actual mm					ØG	N	Ød	
0.75	25	105	14	28	3	75	4	14	0.80
1	30	115	16	33	4	85	4	14	1.10
1.25	38	140	16	42	4	100	4	18	1.65
1.5	44.5	150	16	50	4	110	4	18	1.85
2	57	165	16	62	5	125	4	18	2.20
2.5	76.1	185	16	81	5	145	4	18	2.65
3	88.9	200	18	94	5	160	8	18	3.30
4	108	220	18	113	5	180	8	18	3.65
5	133	250	18	138	5	210	8	18	4.55
6	159	285	18	164	5	240	8	22	5.60
7	193.7	315	22	200	5	270	8	22	7.5
8	219.1	340	20	225	5	295	8	22	7.45
10	267	395	22	273	5	350	12	22	10.30
12	323.9	445	24	331	7	400	12	22	12.00
14	368	505	24	375	7	460	16	22	16.00
16	419.1	565	26	426	7	515	16	26	20.00
18	457.2	615	28	465	7	565	20	26	25.00
20	508	670	30	517	7	620	20	26	31.00
24	610	780	32	618	9	725	20	30	40



COPPER NICKEL FLANGES

composite weld neck flange - outer flange - DIN 86037 / EEMUA 145 / ANSI B16.5 in carbon steel A37 or A105

outer flange - 150 lbs - ANSI B16.5 - galvanized or epoxy coated

STANDARD : ANSI B 16.5

Printable version
PDF version

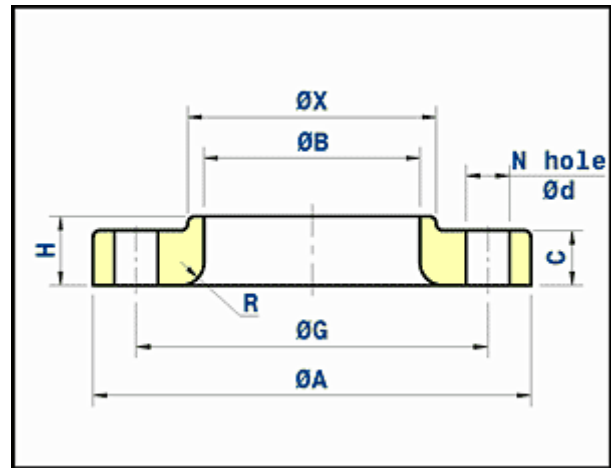

Outside diameter of pipe ØD		ØA	H	C	ØX	ØB	R	Drilling			Theo. weight Kg/piece
nominal inch	actual mm							ØG	N	Ød	
0.5	20	88.9	15.9	11.1	30.2	22	3.2	60.3	4	15.9	0.80
0.75	25	98.4	15.9	12.7	38.1	28	3.2	69.8	4	15.9	0.90
1	30	107.9	17.5	14.3	49.2	33	3.2	79.4	4	15.9	1.00
1.25	38	117.5	20.6	15.9	58.8	41	4.8	88.9	4	15.9	1.30
1.5	44.5	127.0	22.2	17.5	65.1	48	6.4	98.4	4	15.9	1.40
2	57	152.4	25.4	19.0	77.8	62	7.9	120.6	4	19.0	2.30
2.5	76.1	177.8	28.6	22.2	90.5	81	7.9	139.7	4	19.0	3.20
3	88.9	190.5	30.2	23.8	107.9	94	9.5	152.4	4	19.0	3.60
4	108	228.6	33.3	23.8	134.9	113	11.1	190.5	8	19.0	5.90
5	133	254.0	36.5	23.8	163.5	138	11.1	215.9	8	22.2	6.80
6	159	279.4	39.7	25.4	192.1	164	12.70	241.3	8	22.2	8.60
8	219.1	342.9	44.4	28.6	246.1	225	12.70	298.4	8	22.2	13.60
10	267	406.4	49.2	30.2	304.8	273	12.70	361.9	12	25.4	19.50
12	323.9	482.6	55.6	31.7	365.1	330	12.70	431.8	12	25.4	29.00
14	368	533.4	79.4	34.9	400.0	374	12.70	476.2	12	28.6	45.00
16	419.1	596.9	87.3	36.5	457.2	426	12.70	539.7	16	28.6	58.00
18	457.2	635.0	96.8	39.7	504.8	465	12.70	577.8	16	31.7	66.00
20	508	698.5	103.2	42.9	558.8	517	12.70	635.0	20	31.7	84.00
24	610	812.8	111.1	47.6	663.6	618	12.70	749.3	20	34.9	118.00



COPPER NICKEL FLANGES

composite weld neck flange - outer flange - DIN 86037 / EEMUA 145 / ANSI B16.5 in carbon steel A37 or A105

outer flange - 150 lbs - EEMUA 145 - galvanized or epoxy coated

STANDARD : EEMUA Pub. N°145

Printable version
PDF version

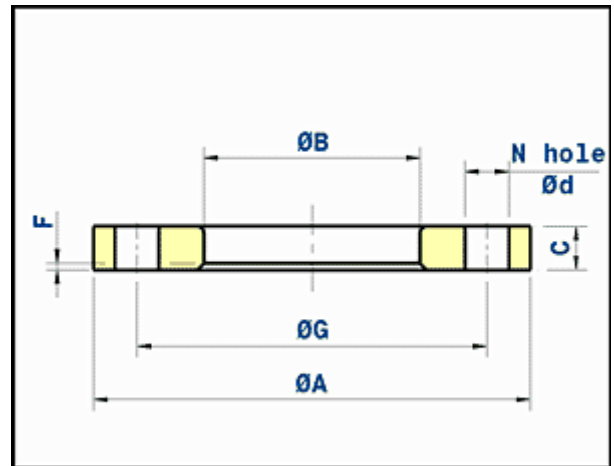

Outside diameter of pipe ØD		ØA	C	ØB	F	Drilling			Theo. weight Kg/piece
nominal inch	actual mm					ØG	N	Ød	
0.5	16	89	14	19	2	60.3	4	15.9	0.60
0.75	25	98	14	28	3	69.8	4	15.9	0.80
1	30	108	14	33	3	79.4	4	15.9	0.90
1.25	38	117	14	41	3	88.9	4	15.9	1.10
1.5	44.5	127	14	48	3	98.4	4	15.9	1.20
2	57	152	18	62	3	120.6	4	19.0	2.10
2.5	76.1	178	18	81	3	139.7	4	19.0	2.60
3	88.9	190	19	94	3	152.4	4	19.0	2.90
4	108	229	24	113	3	190.5	8	19.0	5.90
6	159	279	27	164	4	241.3	8	22.2	8.40
8	219.1	343	31	225	5	298.4	8	22.2	12.35
10	267	406	38	273	5	362.0	12	25.4	19.70
12	323.9	483	41	330	7	431.8	12	25.4	32.20
14	368	533	45	374	7	476.2	12	28.6	38.20
16	419.1	597	51	426	7	539.8	16	28.6	52.15
18	457.2	635	52	465	7	577.8	16	31.8	54.05
20	508	698	58	517	7	635.0	20	31.8	73.20
24	610	813	71	618	9	749.3	20	34.9	114.25
28	711	927	81	727	9	864.0	28	34.9	151.80
32	813	1060	95	829	9	978.0	28	41.1	233.50
36	914	1168	105	931	9	1086.0	32	41.1	294.10



COPPER NICKEL FLANGES

composite weld neck flange - outer flange - DIN 86037 / EEMUA 145 / ANSI B16.5 in carbon steel A37 or A105

outer flange - 300 lbs - ANSI B16.5 - galvanized or epoxy coated

STANDARD : ANSI B 16.5

Printable version

PDF version

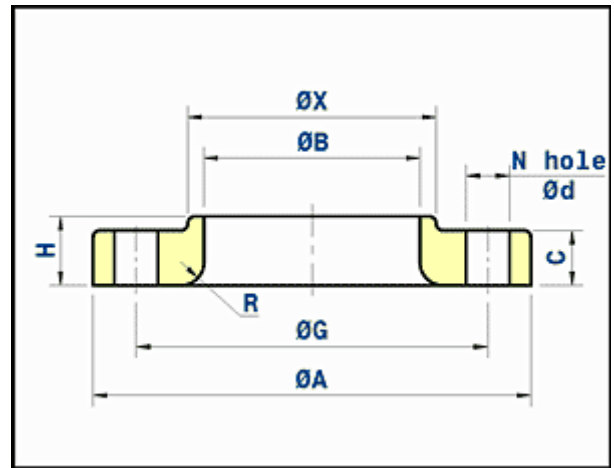

Outside diameter of pipe ØD		ØA	H	C	ØX	ØB	R	Drilling			Theo. weight Kg/piece
nominal inch	actual mm							ØG	N	Ød	
0.5	20	95.2	22.2	14.3	38.1	22	3.2	66.7	4	15.9	1.20
0.75	25	117.5	25.4	15.9	47.6	28	3.2	82.5	4	19.0	1.30
1	30	123.8	27.0	17.5	54.0	33	3.2	88.9	4	19.0	1.40
1.25	38	133.3	27.0	19.0	63.5	41	4.8	98.4	4	19.0	1.80
1.5	44.5	155.6	30.2	20.6	69.8	48	6.4	114.3	4	22.2	2.70
2	57	165.1	33.3	22.2	84.1	62	7.9	127.0	8	19.0	3.20
2.5	76.1	190.5	38.1	25.4	100.0	81	7.9	149.2	8	22.2	4.50
3	88.9	209.5	42.9	28.6	117.5	94	9.5	168.3	8	22.2	5.90
4	108	254.0	47.6	31.7	146.0	113	11.1	200.0	8	22.2	10.00
5	133	279.4	50.8	34.9	177.8	138	11.1	234.9	8	22.2	12.70
6	159	317.5	52.4	36.5	206.4	164	12.7	269.9	12	22.2	17.70
8	219.1	381.0	61.9	41.3	260.3	225	12.7	330.2	12	25.4	26.30
10	267	444.5	95.2	47.6	320.7	273	12.7	387.3	16	28.6	41.00
12	323.9	520.7	101.6	50.8	374.6	330	12.7	450.8	16	31.7	63.00
14	368	584.2	111.1	54.0	425.4	374	12.7	514.3	20	31.7	86.00
16	419.1	647.7	120.6	57.1	482.6	426	12.7	571.5	16	34.9	109.00
18	457.2	711.2	130.2	60.3	533.4	465	12.7	628.6	24	34.9	138.00
20	508	774.7	139.7	63.5	587.4	517	12.7	685.8	24	34.9	170.00
24	610	914.4	152.4	69.8	701.7	618	12.7	812.8	24	41.3	241.00



COPPER NICKEL FLANGES

composite weld neck - inner flange - DIN 86037 /
EEMUA 145 in copper nickel

short inner flange - 16 bar - EEMUA 145

STANDARD : EEMUA Pub. N°145

Printable version

PDF version

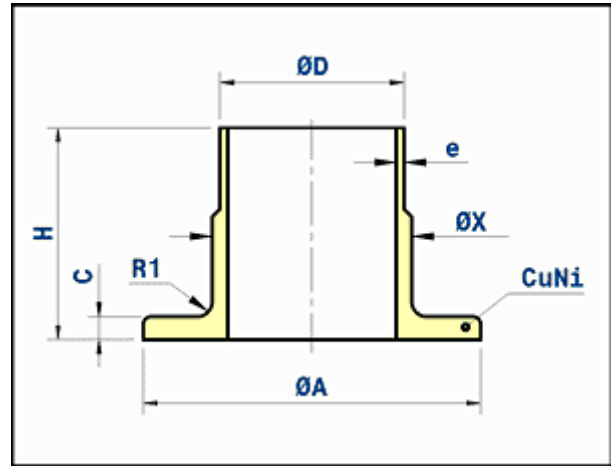

Outside diameter of pipe ØD		Wall thickness e mm	ØA mm	H mm	C mm	ØX mm	R1 mm	Theo. weight Kg/piece
nominal inch	actual mm							
0.5	16	2	40	35	4	18	2	0.07
0.75	25	2	50	40	5	27	3	0.16
1	30	2.5	60	40	5	32	4	0.20
1.25	38	2.5	70	40	5	40	4	0.25
1.5	44.5	2.5	80	45	6	46.5	4	0.42
2	57	2.5	99	45	6	59	5	0.50
2.5	76.1	2.5	120	45	6	78	5	0.67
3	88.9	2.5	130	50	7	91	5	0.86
4	108	3	158	50	7	110	5	1.18
6	159	3	212	50	9	161.5	5	2.20
8	219.1	4	270	50	9	222	5	3.20
10	267	4.5	320	50	9	270	5	3.90
12	323.9	5.5	370	50	11	327	7	6.50
14	368	6.5	430	50	11	371	7	7.45
16	419.1	7	482	50	12	422	7	9.20
18	457.2	8	530	50	12	460	7	11.45
20	508	8.5	585	50	12	511	7	13.40
24	610	10.5	685	60	14	613	9	20.75
28	711	12	800	60	19	719	9	33.35
32	813	13.5	905	60	20.5	821	9	42.25
36	914	15.5	1000	60	22	922	9	49.35



COPPER NICKEL FLANGES

composite weld neck - inner flange - DIN 86037 /
EEMUA 145 in copper nickel

short inner flange - 20 bar - EEMUA 145

STANDARD : EEMUA Pub. N°145

Printable version
PDF version

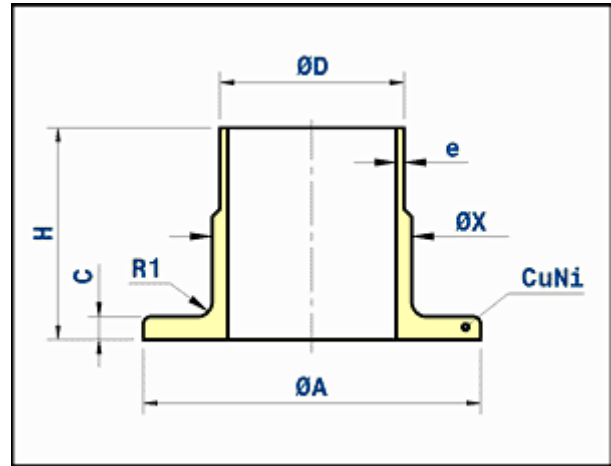

Outside diameter of pipe ØD		Wall thickness e	ØA	H	C	ØX	R1	Theo. weight Kg/piece
nominal inch	actual mm							
0.5	16	2	40	35	4	18	2	0.07
0.75	25	2	50	40	5	27	3	0.16
1	30	2.5	60	40	5	32	4	0.20
1.25	38	2.5	70	40	5	40	4	0.25
1.5	44.5	2.5	80	45	6	46.5	4	0.42
2	57	2.5	99	45	6	59	5	0.50
2.5	76.1	2.5	120	45	6	78	5	0.67
3	88.9	2.5	130	50	7	91	5	0.86
4	108	3	158	50	7	110	5	1.20
6	159	3.5	212	50	9	161.5	5	2.20
8	219.1	4.5	270	50	9	222	5	3.30
10	267	5.5	320	50	9	270	5	4.20
12	323.9	7	370	50	11	327	7	6.80
14	368	8	430	50	11	371	7	8.20
16	419.1	9	482	50	12	422	7	10.35
18	457.2	9.5	530	50	12	460	7	12.40
20	508	11	585	50	12	511	7	15.10
24	610	13	685	60	14	613	9	23.25
28	711	15	800	60	19	719	9	36.80
32	813	17	905	60	20.5	821	9	46.85
36	914	19	1000	60	22	922	9	54.55



COPPER NICKEL FLANGES

solid blind flange - ISO NP10 / ANSI B16.5 in
copper nickel

solid blind flange - 10 bar - ISO NP10

STANDARD : ISO NP 10

Printable version
PDF version

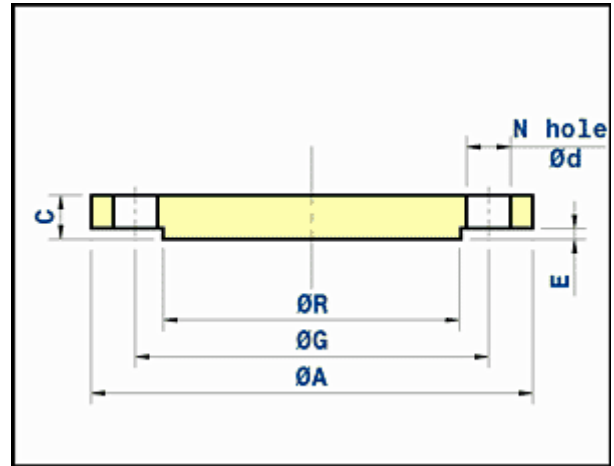

Outside diameter of pipe ØD		ØA mm	C mm	ØR mm	E mm	Drilling			Theo. weight Kg/piece
nominal inch	actual mm					ØG mm	N bolt holes	Ød mm	
0.5	20	95	14	46	2	65	4	14	0.80
0.75	25	105	16	56	2	75	4	14	1.15
1	30	115	16	65	2	85	4	14	1.40
1.25	38	140	18	76	2	100	4	18	2.05
1.5	44.5	150	18	84	3	110	4	18	2.40
2	57	165	20	99	3	125	4	18	3.25
2.5	76.1	185	20	118	3	145	4	18	4.15
3	88.9	200	20	132	3	160	8	18	5.75
4	108	220	22	156	3	180	8	18	7.05
5	133	250	22	184	3	210	8	18	10.10
6	159	285	24	211	3	240	8	22	13.00
7	193.7	315	24	242	3	270	8	22	17.55
8	219.1	340	24	266	3	295	8	22	20.40
10	267	395	26	319	3	350	12	22	29.65
12	323.9	445	26	370	4	400	12	22	37.60
14	368	505	26	429	4	460	16	22	52.45
16	419.1	565	28	480	4	515	16	26	68.40
18	457.2	615	28	530	4	565	20	26	80.95
20	508	670	30	582	4	620	20	26	103.75
24	610	780	34	682	5	725	20	30	149.35



COPPER NICKEL FLANGES

solid blind flange - ISO NP10 / ANSI B16.5 in
copper nickel

solid blind flange - 150 lbs - ANSI B16.5

STANDARD : ANSI B 16.5

Printable version
PDF version

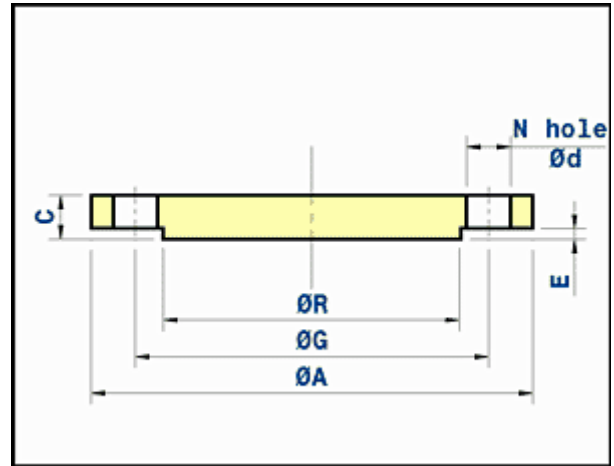

Outside diameter of pipe ØD		ØA mm	C mm	ØR mm	Drilling			Theo. weight Kg/piece
nominal inch	actual mm				ØG mm	N bolt holes	Ød mm	
0.5	20	88.9	11.1	34.9	60.3	4	15.9	0.90
0.75	25	98.4	12.7	42.9	69.8	4	15.9	1.05
1	30	108.0	14.3	50.8	79.4	4	15.9	1.15
1.25	38	117.5	15.9	63.5	88.9	4	15.9	1.50
1.5	44.5	127.0	17.5	73.0	98.4	4	15.9	1.60
2	57	152.4	19.1	92.1	120.6	4	19	2.05
2.5	76.1	177.8	22.2	104.8	139.7	4	19	3.65
3	88.9	190.5	23.8	127.0	152.4	4	19	4.55
4	108	228.6	23.8	157.2	190.5	8	19	9.10
5	133	254.0	23.8	185.7	215.9	8	22.2	10.25
6	159	279.4	25.4	215.9	241.3	8	22.2	13.70
8	219.1	342.9	28.6	269.9	298.4	8	22.2	22.80
10	267	406.4	30.2	323.8	361.9	12	25.4	36.45
12	323.9	482.6	31.8	381.0	431.8	12	25.4	57.00
14	368	533.4	34.9	425.1	476.2	12	28.6	67.25
16	419.1	596.9	36.5	482.6	539.7	16	28.6	87.80
18	457.2	635.0	39.7	533.4	577.8	16	31.7	108.30
20	508	698.5	42.9	584.2	635.0	20	31.7	140.25
24	610	812.8	47.6	692.1	749.3	20	34.9	212.05



COPPER NICKEL FLANGES

solid blind flange - ISO NP10 / ANSI B16.5 in copper nickel

solid blind flange - 300 lbs - ANSI B16.5

STANDARD : ANSI B 16.5

Printable version
PDF version

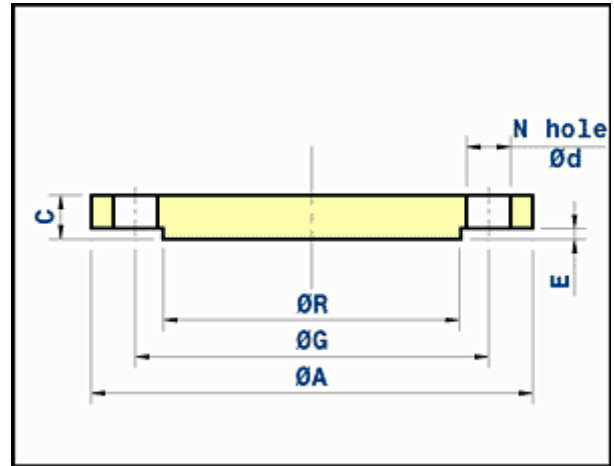

Outside diameter of pipe ØD		ØA mm	C mm	ØR mm	Drilling			Theo. weight Kg/piece
nominal inch	actual mm				ØG mm	N bolt holes	Ød mm	
0.5	20	95.2	14.3	34.9	66.7	4	15.9	1.15
0.75	25	117.5	15.9	42.9	82.5	4	19	1.70
1	30	123.8	17.5	50.8	88.9	4	19	2.30
1.25	38	133.3	19.0	63.5	98.4	4	19	2.85
1.5	44.5	155.6	20.6	73.0	114.3	4	22.2	3.40
2	57	165.1	22.2	92.1	127.0	8	19	4.00
2.5	76.1	190.5	25.4	104.8	149.2	8	22.2	6.30
3	88.9	209.5	28.6	127.0	168.3	8	22.2	8.00
4	108	254.0	31.8	157.2	200.0	8	22.2	13.70
5	133	279.4	34.9	185.7	234.9	8	22.2	18.25
6	159	317.5	36.5	215.9	269.9	12	22.2	26.20
8	219.1	381.0	41.3	269.9	330.2	12	25.4	41.60
10	267	444.5	47.6	323.8	387.3	16	28.6	65.55
12	323.9	520.7	50.8	381.0	450.8	16	31.7	94.60
14	368	584.2	54.0	425.1	514.3	20	31.7	122.0
16	419.1	647.7	57.2	482.6	571.5	20	34.9	158.45
18	457.2	711.2	60.3	533.4	628.6	24	34.9	201.80
20	508	774.7	63.5	584.2	685.8	24	34.9	254.20
24	610	914.4	69.8	692.1	812.8	24	41.3	389.90



COPPER NICKEL FLANGES

solid slip on flange - DIN 86033 / EEMUA 145 /
ANSI B16.5 in copper nickel

solid slip on flange - 10 bar - DIN 86033

STANDARD : DIN 86033

Printable version
PDF version

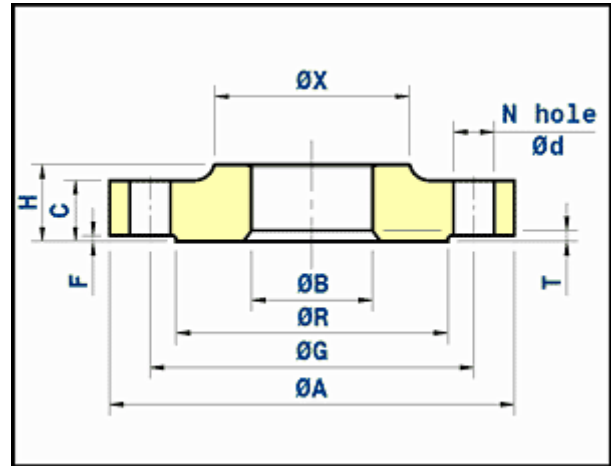

Outside diameter of pipe ØD		ØA	H	C	ØX	ØR	ØB	F	T	Drilling			Theo. weight Kg/piece
nominal inch	actual mm									ØG	N bolt holes	Ød	
0.375	16	90	18	12	26	40	16.20	2		60	4	14	0.52
0.5	20	95	18	12	30	45	20.20	2		65	4	14	0.57
0.75	25	105	18	12	35	58	25.20	2		75	4	14	0.71
1	30	115	18	12	40	68	30.20	2		85	4	14	0.86
1.25	38	140	20	14	49	78	38.25	2		100	4	18	1.47
1.5	44.5	150	20	14	56	88	44.75	3		110	4	18	1.60
2	57	165	22	16	69	102	57.30	3		125	4	18	2.20
2.5	76.1	185	22	16	88	122	76.30	3		145	4	18	2.66
3	88.9	200	24	18	101	138	89.40	3		160	8	18	3.32
4	108	220	28	20	120	158	108.40	5		180	8	18	4.31
5	133	250	28	20	146	188	133.65	5	7	210	8	18	5.37
6	159	285	30	22	172	212	159.65	5	7	240	8	23	6.37
7	193.7	315	32	22	209	242	195.00	5	7	270	8	23	7.22
8	219.1	340	32	24	234	268	220.00	5	7	295	8	23	9.12
10	267	395	34	26	284	320	268.20	6	7	350	12	23	12.10
12	323.9	445	36	26	343	370	325.35	6	7	400	12	23	13.70
14	368	505	38	28	389	430	369.35	6	7	460	16	23	19.30
16	419.1	565	40	28	442	482	420.50	6	7	515	16	27	23.20
18	457.2	615	42	28	482	530	458.50	6	7	565	20	27	27.90
20	508	670	47	31	535	585	509.50	7	8	620	20	27	35.00
24	610	780	49	31	640	685	612.00	8	8	725	20	30	42.90



COPPER NICKEL FLANGES

solid slip on flange - DIN 86033 / EEMUA 145 /
ANSI B16.5 in copper nickel

solid slip on flange - 150 lbs - ANSI B16.5

STANDARD : ANSI B 16.5

Printable version
PDF version

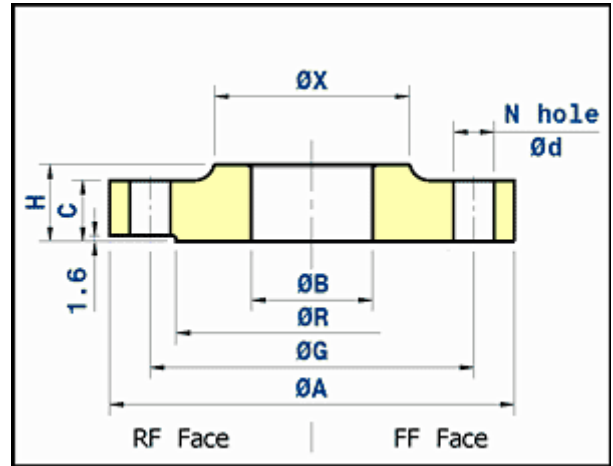

Outside diameter of pipe ØD		ØA mm	H mm	C mm	ØX mm	ØR mm	ØB mm	Drilling			Theo. weight Kg/piece
nominal inch	actual mm							ØG mm	N bolt holes	Ød mm	
0.5	20	88.9	15.9	11.1	30.2	34.9	20.2	60.3	4	15.9	0.90
0.75	25	98.4	15.9	12.7	38.1	42.9	25.2	69.8	4	15.9	1.10
1	30	107.9	17.5	14.3	49.2	50.8	30.2	79.4	4	15.9	1.20
1.25	38	117.5	20.6	15.9	58.7	63.5	38.3	88.9	4	15.9	1.50
1.5	44.5	127.0	22.2	17.5	65.1	73.0	44.8	98.4	4	15.9	1.60
2	57	152.4	25.4	19.1	77.8	92.1	57.4	120.6	4	19.0	2.70
2.5	76.1	177.8	28.6	22.2	90.5	104.8	76.5	139.7	4	19.0	4.10
3	88.9	190.5	30.2	23.8	107.9	127.0	89.4	152.4	4	19.0	4.10
4	108	228.6	33.3	23.8	134.9	157.2	108.5	190.5	8	19.0	7.00
5	133	254.0	36.5	23.8	163.5	185.7	133.8	215.9	8	22.2	8.00
6	159	279.4	39.7	25.4	192.1	215.9	159.8	241.3	8	22.2	9.90
8	219.1	342.9	44.4	28.6	246.1	269.9	220.3	298.4	8	22.2	15.70
10	267	406.4	49.2	30.2	304.8	323.8	268.4	361.9	12	25.4	22.80
12	323.9	482.6	55.6	31.8	365.1	381.0	325.4	431.8	12	25.4	33.90
14	368	533.4	57.1	34.9	400.0	425.1	369.5	476.2	12	28.6	45.00
16	419.1	596.9	63.5	36.5	457.2	482.6	420.5	539.7	16	28.6	49.00
18	457.2	635.0	68.3	39.7	504.8	533.4	458.7	577.8	16	31.7	63.00
20	508	698.5	73.0	42.9	558.8	584.2	509.5	635.0	20	31.7	81.50
24	610	812.8	82.5	47.6	663.6	692.1	611.5	749.3	20	34.9	105.55



COPPER NICKEL FLANGES

solid slip on flange - DIN 86033 / EEMUA 145 /
ANSI B16.5 in copper nickel

solid slip on flange - 16&20 bar - EEMUA 145

STANDARD : EEMUA Pub. N°145

Printable version
PDF version

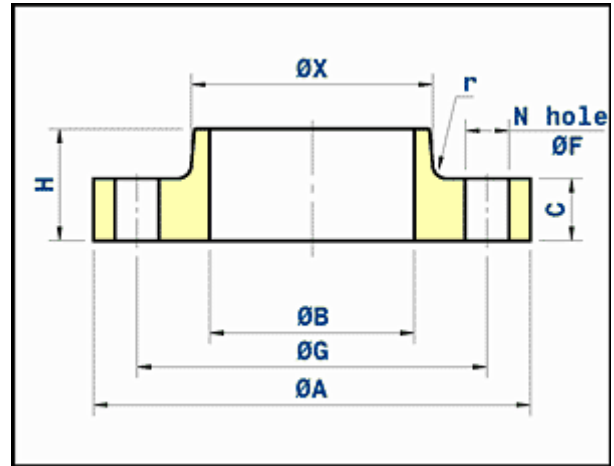

Outside diameter of pipe ØD		ØA	H	C	ØX	ØB	r	Drilling			Theo. weight Kg/piece
nominal inch	actual mm							ØG	N bolt holes	Ød	
0.5	16	89	20	14	23	16.07	4	60.3	4	15.9	1.15
0.75	25	98	24	16	32	25.08	4	69.8	4	15.9	1.20
1	30	108	24	16	47	30.08	4	79.4	4	15.9	1.30
1.25	38	117	26	17	51	38.10	6	88.9	4	15.9	1.70
1.5	44.5	127	26	20	61	44.60	6	98.4	4	15.9	1.80
2	57	152	28	25	73	57.23	6	120.6	4	19	2.90
2.5	76.1	178	32	27	91	76.33	6	139.7	4	19	4.30
3	88.9	190	34	27	105	89.18	6	152.4	4	19	4.40
4	108	229	40	27	135	108.38	8	190.5	8	19	7.30



COPPER NICKEL FLANGES

solid slip on flange - DIN 86033 / EEMUA 145 /
ANSI B16.5 in copper nickel

solid slip on flange - 300 lbs - ANSI B16.5

STANDARD : ANSI B 16.5

Printable version
PDF version

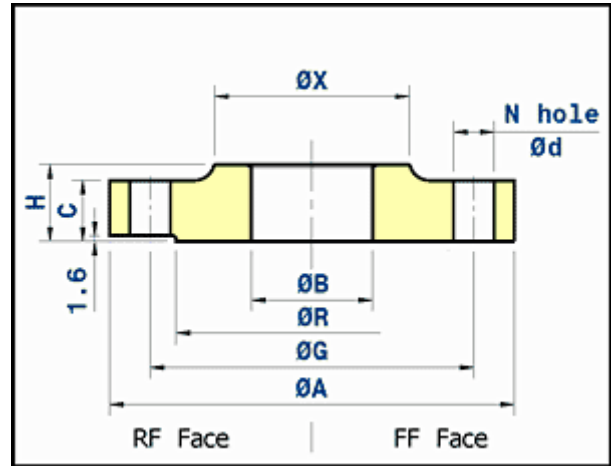

Outside diameter of pipe ØD		ØA	H	C	ØX	ØR	ØB	Drilling			Theo. weight Kg/piece
nominal inch	actual mm							ØG	N bolt holes	Ød	
0.5	20	95.2	22.2	14.3	38.1	34.9	20.2	66.7	4	15.9	0.90
0.75	25	117.5	25.4	15.9	47.6	42.9	25.2	82.5	4	19	1.40
1	30	123.8	27.0	17.5	54.0	50.8	30.2	88.9	4	19	1.70
1.25	38	133.3	27.0	19.0	63.5	63.5	38.3	98.4	4	19	2.00
1.5	44.5	155.6	30.2	20.6	69.8	73.0	44.8	114.3	4	22.2	3.00
2	57	165.1	33.3	22.2	84.1	92.1	57.4	127.0	8	19	3.40
2.5	76.1	190.5	38.1	25.4	100.0	104.8	76.5	149.2	8	22.2	5.10
3	88.9	209.5	42.9	28.6	117.5	127.0	89.4	168.3	8	22.2	6.80
4	108	254.0	47.6	31.8	146.0	157.2	108.5	200.0	8	22.2	11.30
5	133	279.4	50.8	34.9	177.8	185.7	133.8	234.9	8	22.2	14.20
6	159	317.5	52.4	36.5	206.4	215.9	159.8	269.9	12	22.2	18.30
8	219.1	381.0	61.9	41.3	260.3	269.9	220.3	330.2	12	25.4	28.20
10	267	444.5	66.7	47.6	320.7	323.8	268.4	387.3	16	28.6	39.50
12	323.9	520.7	73.0	50.8	374.6	381.0	325.4	450.8	16	31.7	57.70
14	368	584.2	76.2	54.0	425.4	425.1	369.5	514.3	20	31.7	80.60
16	419.1	647.7	82.5	57.2	482.6	482.6	420.5	571.5	20	34.9	102.10
18	457.2	711.2	88.9	60.3	533.4	533.4	458.7	628.5	24	34.9	125.20
20	508	774.7	95.2	63.5	587.4	584.2	509.5	685.8	24	34.9	154.70
24	610	914.4	106.4	69.8	701.7	692.1	611.5	812.8	24	41.3	240.65



COPPER NICKEL FLANGES

solid socket welding flange - ANSI B16.5 in copper nickel

solid socket welding flange - 150 lbs - ANSI B16.5

STANDARD : ANSI B 16.5

Printable version

PDF version

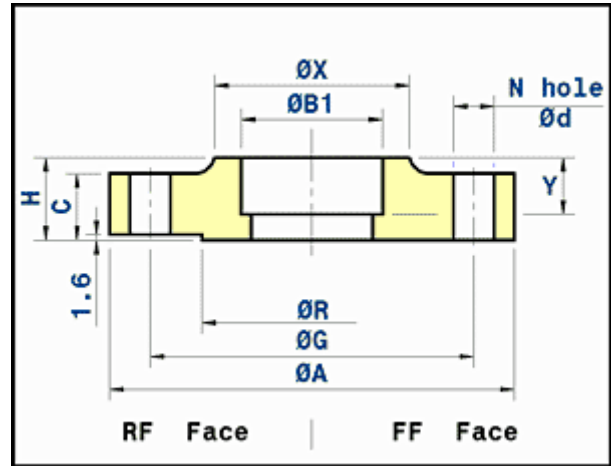

Outside diameter of pipe ØD		ØA	H	C	ØX	ØR	ØB1	Y	Drilling			Theo. weight Kg/piece
nominal inch	actual mm								ØG	N bolt holes	Ød	
0.5	20	88.9	15.9	11.1	30.2	34.9	20.2	9.5	60.3	4	15.9	0.80
0.75	25	98.4	15.9	12.7	38.1	42.9	25.2	11.1	69.8	4	15.9	1.10
1	30	107.9	17.5	14.3	49.2	50.8	30.2	12.7	79.4	4	15.9	1.20
1.25	38	117.5	20.6	15.9	58.7	63.5	38.3	14.3	88.9	4	15.9	1.50
1.5	44.5	127.0	22.2	17.5	65.1	73.0	44.8	15.9	98.4	4	15.9	1.60
2	57	152.4	25.5	19.1	77.8	92.1	57.4	17.5	120.6	4	19	2.70
2.5	76.1	177.8	28.6	22.2	90.5	104.8	76.5	19.0	139.7	4	19	4.10
3	88.9	190.5	30.2	23.8	107.9	127.0	89.4	20.6	152.4	4	19	4.10
4	108	228.6	33.3	23.8	134.9	157.2	108.5	23.8	190.5	8	19	7.00



COPPER NICKEL FLANGES

solid socket welding flange - ANSI B16.5 in copper nickel

solid socket welding flange - 300 lbs - ANSI B16.5

STANDARD : ANSI B 16.5

Printable version

PDF version

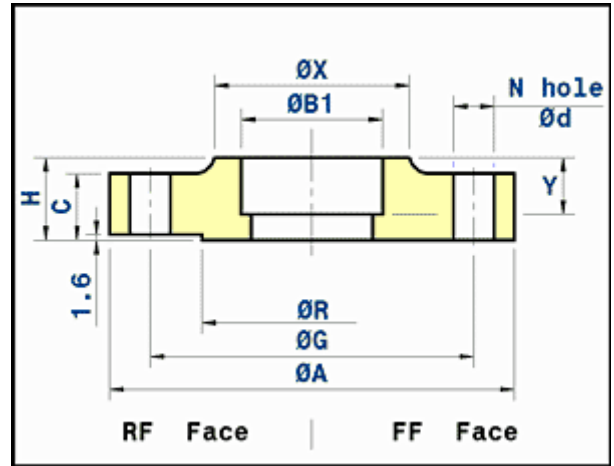

Outside diameter of pipe ØD		ØA	H	C	ØX	ØR	ØB1	Y	Drilling			Theo. weight Kg/piece
nominal inch	actual mm								ØG	N bolt holes	Ød	
0.5	20	95.2	22.2	14.3	38.1	34.9	20.2	9.5	66.7	4	15.9	0.90
0.75	25	117.5	25.4	15.9	47.6	42.9	25.2	11.1	82.5	4	19	1.40
1	30	123.8	27.0	17.5	54.0	50.8	30.2	12.7	88.9	4	19	1.70
1.25	38	133.3	27.0	19.0	63.5	63.5	38.3	14.3	98.4	4	19	2.00
1.5	44.5	155.6	30.2	20.6	69.8	73.0	44.8	15.9	114.3	4	22.2	3.00
2	57	165.1	33.3	22.2	84.1	92.1	57.4	17.5	127.0	8	19	3.40
2.5	76.1	190.5	38.1	25.4	100.0	104.8	76.5	19.0	149.2	8	22.2	5.10
3	88.9	209.5	42.9	28.6	117.5	127.0	89.4	20.6	168.3	8	22.2	6.80
4	108	254.0	47.60	31.8	146.0	157.2	108.5	23.8	200.0	8	22.2	11.30



COPPER NICKEL FLANGES

solid welding neck flange - DIN 2632 / EEMUA 145 /
ANSI B16.5 in copper nickel

solid welding neck flange - 10 bar - DIN 2632

STANDARD : DIN 2632

Printable version
PDF version

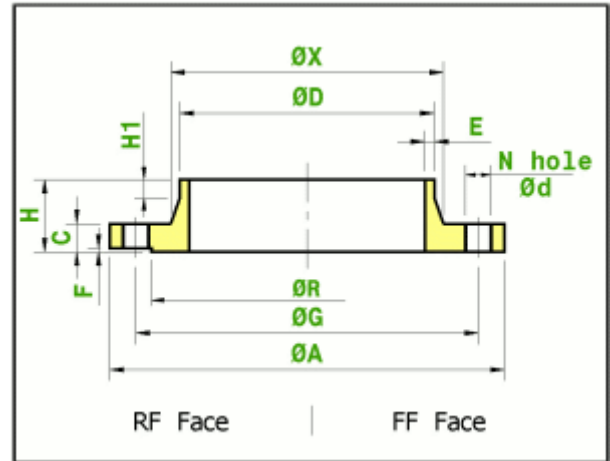

Outside diameter of pipe ØD		ØA mm	H mm	C mm	ØX mm	ØR mm	F mm	E mm	Y mm	Drilling			Theo. weight Kg/piece
nominal inch	actual mm									ØG mm	N bolt holes	Ød mm	
0.5	20	95	35	14	30	45	2		6	65	4	14	0.74
0.75	25	105	38	16	38	58	2		6	75	4	14	1.08
1	30	115	38	16	42	68	2		6	85	4	14	1.30
1.25	38	140	40	16	52	78	2		6	100	4	18	1.92
1.5	44.5	150	42	16	60	88	3		7	110	4	18	2.11
2	57	165	45	18	72	102	3		8	125	4	18	2.88
2.5	76.1	185	45	18	90	122	3		10	145	4	18	3.48
3	88.9	200	50	20	105	138	3		10	160	8	18	4.20
4	108	220	52	20	125	158	3		12	180	8	18	5.25
5	133	250	55	22	150	188	3		12	210	8	18	7.15
6	159	285	55	22	175	212	3		12	240	8	22	8.80
7	193.7	315	60	24	210	242	3		12	270	8	22	11.19
8	219.1	340	62	24	235	268	3		16	295	8	22	12.84
10	267	395	68	26	285	320	3		16	350	12	22	16.70
12	323.9	445	68	26	344	370	4		16	400	12	22	19.77
14	368	505	68	26	385	430	4		16	460	16	22	26.81
16	419.1	565	72	26	440	482	4		16	515	16	26	32.49
20	508	670	75	28	542	585	4		16	620	20	26	43.28
24	610	780	80	28	642	685	5		18	725	20	30	50.67



COPPER NICKEL FLANGES

solid welding neck flange - DIN 2632 / EEMUA 145 /
ANSI B16.5 in copper nickel

solid welding neck flange - 150 lbs - ANSI B16.5

STANDARD : ANSI B 16.5

Printable version
PDF version

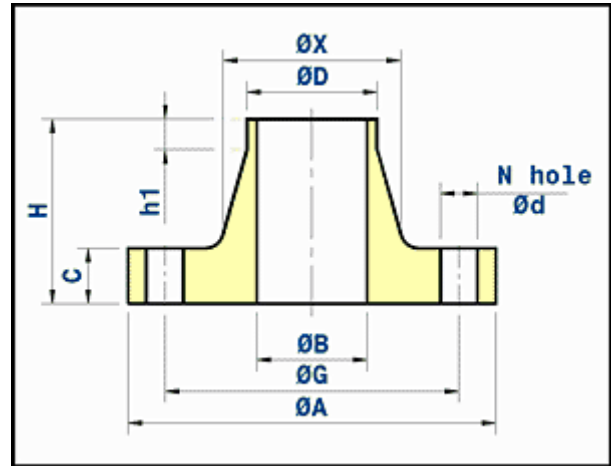

Outside diameter of pipe ØD		ØA	H	C	ØX	ØR	Drilling			Theo. weight Kg/piece
nominal inch	actual mm						ØG	N bolt holes	Ød	
0.5	20	88.9	47.6	11.1	30.2	34.9	60.3	4	15.9	0.68
0.75	25	98.4	52.4	12.7	38.1	42.9	69.8	4	15.9	0.91
1	30	107.9	55.6	14.3	49.2	50.8	79.4	4	15.9	1.25
1.25	38	117.5	57.1	15.9	58.7	63.5	88.9	4	15.9	1.58
1.5	44.5	127.0	61.9	17.5	65.1	73.0	98.4	4	15.9	2.05
2	57	152.4	63.5	19.1	77.8	92.10	120.6	4	19	3.05
2.5	76.1	177.8	69.8	22.2	90.5	104.8	139.7	4	19	5.10
3	88.9	190.5	69.8	23.8	107.9	127.0	152.4	4	19	5.20
4	108	228.6	76.2	23.8	134.9	157.2	190.5	8	19	7.90
5	133	254.0	88.9	23.8	163.5	185.7	215.9	8	22.2	10.10
6	159	279.4	88.9	25.4	192.1	215.9	241.3	8	23	12.20
8	219.1	342.9	101.6	28.6	246.1	269.9	298.4	8	23	20.00
10	267	406.4	101.6	30.2	304.8	323.8	361.9	12	25.4	27.00
12	323.9	482.6	114.3	31.8	365.1	381.0	431.8	12	25.4	42.00
14	368	533.4	127	34.9	400.0	425.1	476.2	12	28.6	53.00
16	419.1	596.9	127	36.5	457.2	482.6	539.7	16	28.6	66.00
18	457.2	635.0	139.7	39.7	504.8	533.4	577.8	16	31.7	72.00
20	508	698.5	144.5	42.9	558.8	584.2	635.0	20	31.7	87.00
24	610	812.8	152.4	47.6	663.6	692.1	749.3	20	34.9	134.00



COPPER NICKEL FLANGES

solid welding neck flange - DIN 2632 / EEMUA 145 /
ANSI B16.5 in copper nickel

solid welding neck flange - 16 bar - EEMUA 145

STANDARD : EEMUA Pub. N°145

Printable version
PDF version

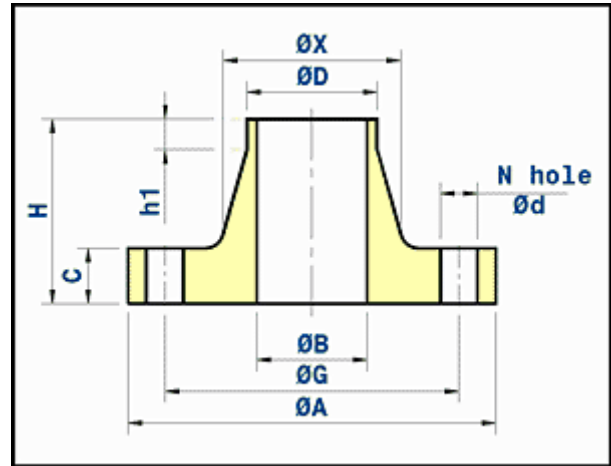

Outside diameter of pipe ØD		ØA	H	C	ØX	ØB	h1	Drilling			Theo. weight Kg/piece
nominal inch	actual mm							ØG	N	Ød	
0.5	16	89	48	14	23	12.00	8	60.3	4	15.9	0.74
0.75	25	98	52	16	32	21.00	7	69.8	4	15.9	1.04
1	30	108	56	16	42	25.00	8	79.4	4	15.9	1.36
1.25	38	117	57	17	51	33.03	8	88.9	4	15.9	1.70
1.5	44.5	127	62	20	61	39.53	7	98.4	4	15.9	2.38
2	57	152	64	25	73	52.16	9	120.6	4	19	3.93
2.5	76.1	178	70	27	91	71.23	8	139.7	4	19	5.62
3	88.9	190	70	27	105	84.08	8	152.4	4	19	6.27
4	108	229	76	27	135	102.13	8	190.5	8	19	9.53
6	159	279	89	27	192	153.75	8	241.3	8	22.2	13.65
8	219.1	343	98	31	246	211.10	8	298.4	8	22.2	21.19
10	267	406	98	31	305	257.97	8	362	12	25.4	29.52
12	323.9	483	98	35	365	312.83	8	431.8	12	25.4	44.77
14	368	533	99	41	400	354.22	8	476.2	12	28.6	57.27
16	419.1	597	106	43	457	404.17	8	539.8	16	28.6	74.40
18	457.2	635	113	45	505	441.50	8	577.8	16	31.8	88.16
20	508	698	118	45	559	490.50	8	635.0	20	31.8	106.20
24	610	813	137	49	664	589.50	8	749.3	20	34.9	153.15
28	711	927	145	72	748	687.50	8	864.0	28	34.9	255.28
32	813	1060	160	72	876	786.50	8	978.0	28	41.1	291.45
36	914	1168	175	72	984	883.50	8	1086.0	32	41.1	356.45



COPPER NICKEL FLANGES

solid welding neck flange - DIN 2632 / EEMUA 145 /
ANSI B16.5 in copper nickel

solid welding neck flange - 16 bar - DIN 2633

STANDARD : DIN 2633

Printable version
PDF version

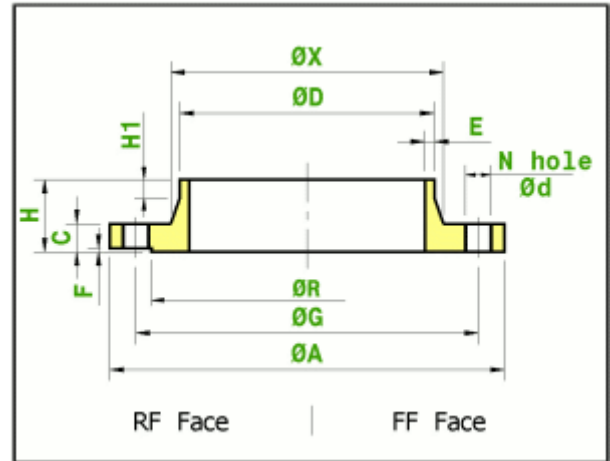

Outside diameter of pipe ØD		ØA mm	H mm	C mm	ØX mm	ØR mm	F mm	E mm	H1 mm	Drilling			Theo. weight Kg/piece
nominal inch	actual mm									ØG mm	N bolt holes	Ød mm	
0.5	20	95	35	14	30	45	2		6	65	4	14	0.74
0.75	25	105	38	16	38	58	2		6	75	4	14	1.08
1	30	115	38	16	42	68	2		6	85	4	14	1.30
1.25	38	140	40	16	52	78	2		6	100	4	18	1.92
1.5	44.5	150	42	16	60	88	3		7	110	4	18	2.11
2	57	165	45	18	72	102	3		8	125	4	18	2.88
2.5	76.1	185	45	18	90	122	3		10	145	4	18	3.48
3	88.9	200	50	20	105	138	3		10	160	8	18	4.20
4	108	220	52	20	125	158	3		12	180	8	18	5.25
5	133	250	55	22	150	188	3		12	210	8	18	7.15
6	159	285	55	22	175	212	3		12	240	8	22	8.80
7	193.7	315	60	24	210	242	3		12	270	8	22	11.19
8	219.1	340	62	24	235	268	3		16	295	12	22	12.50
10	267	405	70	26	285	320	3		16	355	12	26	17.72
12	323.9	460	78	28	344	378	4		16	410	12	26	25.00
14	368	520	82	30	390	438	4		16	470	16	26	35.45
16	419.1	580	85	32	445	490	4		16	525	16	30	45.21
20	508	715	90	34	548	610	4		16	650	20	33	69.30
24	610	840	95	36	652	725	5		18	770	20	36	85.65



COPPER NICKEL FLANGES

solid welding neck flange - DIN 2632 / EEMUA 145 /
ANSI B16.5 in copper nickel

solid welding neck flange - 20 bar - EEMUA 145

STANDARD : EEMUA Pub. N°145

Printable version
PDF version

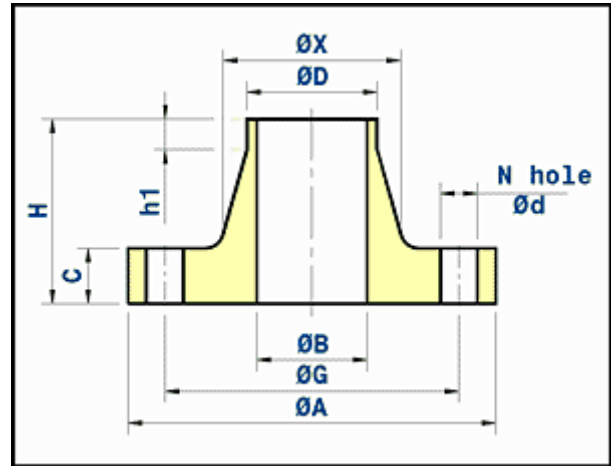

Outside diameter of pipe ØD		ØA	H	C	ØX	ØB	h1	Drilling			Theo. weight Kg/piece
nominal inch	actual mm							ØG	N bolt holes	Ød	
0.5	16	89	48	14	23	12.00	8	60.3	4	15.9	0.74
0.75	25	98	52	16	32	21.00	7	69.8	4	15.9	1.04
1	30	108	56	16	42	25.00	8	79.4	4	15.9	1.36
1.25	38	117	57	17	51	33.03	8	88.9	4	15.9	1.70
1.5	44.5	127	62	20	61	39.53	7	98.4	4	15.9	2.38
2	57	152	64	25	73	52.16	9	120.6	4	19	3.93
2.5	76.1	178	70	27	91	71.23	8	139.7	4	19	5.62
3	88.9	190	70	27	105	84.08	8	152.4	4	19	6.27
4	108	229	76	27	135	102.13	8	190.5	8	19	9.53
6	159	279	89	27	192	152.38	8	241.3	8	22.2	13.99
8	219.1	343	98	31	246	210.10	8	298.4	8	22.2	21.57
10	267	406	98	31	305	255.93	8	362.0	12	25.4	30.47
12	323.9	483	98	35	365	309.74	8	431.8	12	25.4	46.56
14	368	533	99	41	400	351.00	8	476.2	12	28.6	59.49
16	419.1	597	106	43	457	399.84	8	539.8	16	28.6	78.03
18	457.2	635	113	45	505	438.50	8	577.8	16	31.8	91.08
20	508	698	118	45	559	486.50	8	635.0	20	31.8	110.65
24	610	813	137	49	664	584.50	8	749.3	20	34.9	160.79
28	711	927	145	72	748	681.50	8	864.0	28	34.9	249.09
32	813	1060	160	72	876	779.50	8	978.0	28	41.1	303.95
36	914	1168	175	72	984	876.50	8	1086.0	32	41.1	371.80



COPPER NICKEL FLANGES

solid welding neck flange - DIN 2632 / EEMUA 145 /
ANSI B16.5 in copper nickel

solid welding neck flange - 300 lbs - ANSI B16.5

STANDARD : ANSI B 16.5

Printable version
PDF version

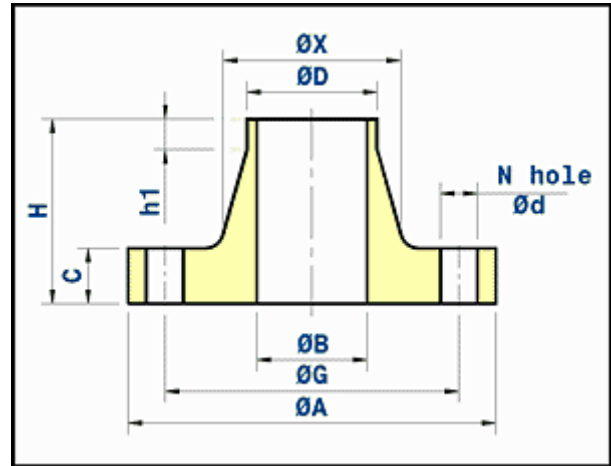

Outside diameter of pipe ØD		ØA	H	C	ØX	ØR	Drilling			Theo. weight Kg/piece
nominal inch	actual mm						ØG	N bolt holes	Ød	
0.5	20	95.2	52.4	14.3	38.1	34.9	66.7	4	15.9	1.72
0.75	25	117.5	57.1	15.9	47.6	42.9	82.5	4	19	2.06
1	30	123.8	61.9	17.5	54.0	50.8	88.9	4	19	2.29
1.25	38	133.3	65.1	19.0	63.5	63.5	98.4	4	19	2.86
1.5	44.5	155.6	68.3	20.6	69.8	73.0	114.3	4	22.2	4.01
2	57	165.1	69.8	22.2	84.1	92.1	127.0	8	19	4.58
2.5	76.1	190.5	76.2	25.4	100.0	104.8	149.2	8	22.2	5.73
3	88.9	209.5	79.4	28.6	117.5	127.0	168.3	8	22.2	8.02
4	108	254.0	85.7	31.8	146.1	157.2	200.0	8	22.2	12.60
5	133	279.4	98.4	34.9	177.8	185.7	234.9	8	22.2	17.90
6	159	317.5	98.4	36.5	206.4	215.9	269.9	12	22.2	21.76
8	219.1	381.0	111.1	41.3	260.4	269.9	330.2	12	25.4	34.35
10	267	444.5	117.5	47.6	320.7	323.8	387.3	16	28.6	46.95
12	323.9	520.7	130.2	50.8	374.6	381.0	450.8	16	31.7	70.99
14	368	584.2	142.9	54.0	425.4	425.1	514.3	20	31.7	96.18
16	419.1	647.7	146.1	57.2	482.6	482.6	571.5	20	34.9	127.10
18	457.2	711.2	158.7	60.3	533.3	533.4	628.6	24	34.9	158.01
20	508	774.7	161.9	63.5	587.4	584.2	685.8	24	34.9	195.80
24	610	914.4	168.3	69.8	701.7	692.1	812.8	24	41.3	283.00