

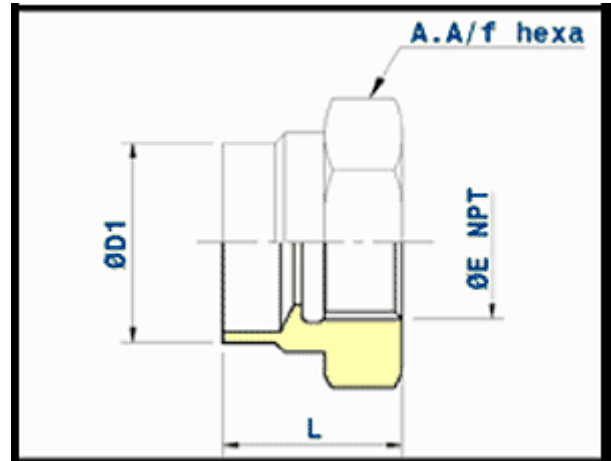

COPPER NICKEL FORGED AND MACHINED FITTINGS

adaptors in copper nickel
butt welding ends x female thread

Printable version
 PDF version



Outside diameter of pipe				ØE Thread (NPT)	L mm	A.A/f mm	Theoretical weight Kg/piece		
nominal inch	ØD1 x ØE actual mm								
0.38	x	0.5	16	x	20	1/2"	34	27	0.07
0.5	x	0.75	20	x	25	3/4"	37	32	0.1
0.75	x	0.75	25	x	25	3/4"	34	32	0.15
0.75	x	1	25	x	30	1"	41	41	0.19
1	x	1	30	x	30	1"	39	41	0.25
1.25	x	1.5	38	x	44.5	1" 1/2	50	55	0.35
1.5	x	1.5	44.5	x	44.5	1" 1/2	47	55	0.40
2	x	1.5	57	x	44.5	1" 1/2	47	70	0.5
2	x	2	57	x	57	2"	51	70	0.5



COPPER NICKEL FORGED AND MACHINED FITTINGS

adaptors in copper nickel
butt welding ends x male thread

Printable version
PDF version

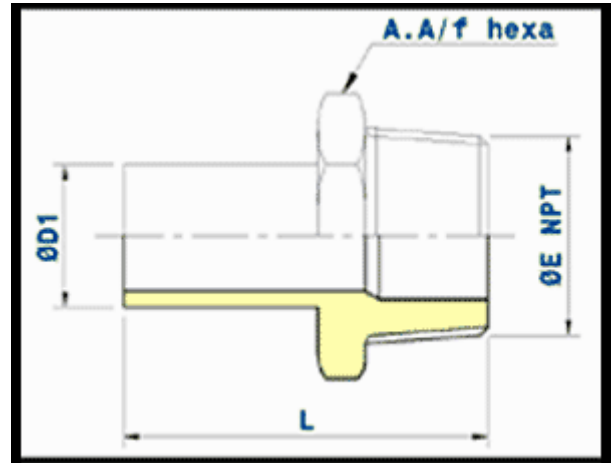

Outside diameter of pipe				ØE Thread (NPT)	L mm	A.A/f mm	Theoretical weight Kg/piece		
nominal inch		ØD1 x ØE actual mm							
0.38	x	0.5	16	x	20	1/2"	40	27	0.15
0.5	x	0.5	20	x	20	1/2"	40	27	0.16
0.75	x	0.75	25	x	25	3/4"	45	32	0.22
1	x	0.75	30	x	25	3/4"	48	32	0.28
1	x	1	30	x	30	1"	53	38	0.32
1.075	x	1.5	38	x	44.5	1" 1/2	60	50	0.50
1.5	x	1.5	44.5	x	44.5	1" 1/2	60	50	0.60
2	x	1.5	57	x	44.5	1" 1/2	65	65	0.85
2	x	2	57	x	57	2"	70	65	0.98



CATALOG

copper nickel forged and machined fittings

bosses in copper nickel

Printable version
PDF version

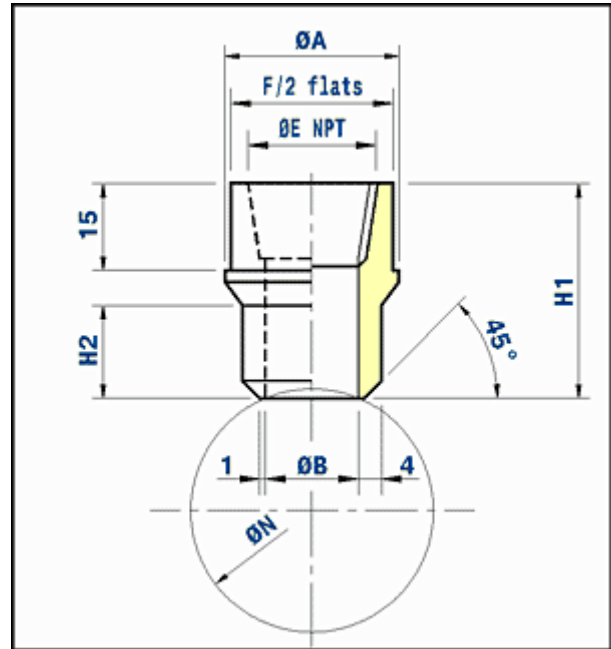

Outside diameter of pipe		ØE Thread (NPT)	ØA mm	ØB mm	H1 mm	H2 mm	F/2 flats mm	Theoretical weight Kg/piece
nominal inch	actual mm							
0.5	16	1/2"	35	17	37	13	31	0.17
0.75	25	3/4"	40	23	39	16	35	0.13
1	30	1"	45	29	43	16	40	0.28
1.5	44.5	1" 1/2	60	43.5	50	20	55	0.48



COPPER NICKEL FORGED AND MACHINED FITTINGS

connectors in copper nickel

female union connector - butt welding ends x female thread

Printable version
PDF version

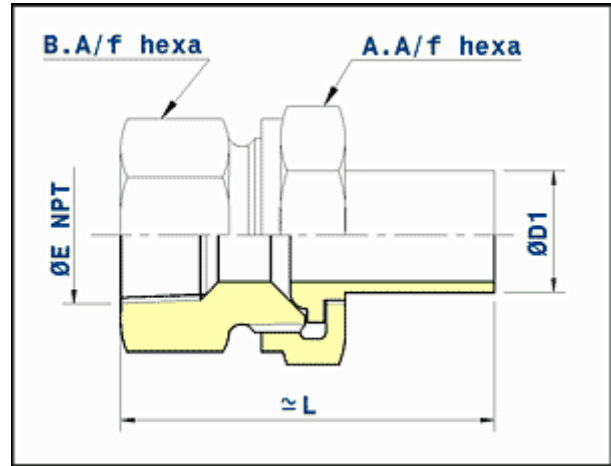

Outside diameter of pipe		ØE Thread (NPT)	L mm	A.A/f mm	B.A/f mm	Theoretical weight Kg/piece
nominal inch	ØD1 actual mm					
0.38	16	1/2"	60	42	27	0.25
0.5	20	1/2"	61	42	27	0.28
0.75	25	3/4"	69	50	32	0.38
1	30	1"	73	60	41	0.41
1.25	38	1" 1/4	87	70	50	0.68
1.5	44.5	1" 1/2	87	70	55	0.77
2	57	2"	96	85	70	1.05



COPPER NICKEL FORGED AND MACHINED FITTINGS

connectors in copper nickel

female union connector - socket welding or capillary ends x female thread

Printable version
PDF version

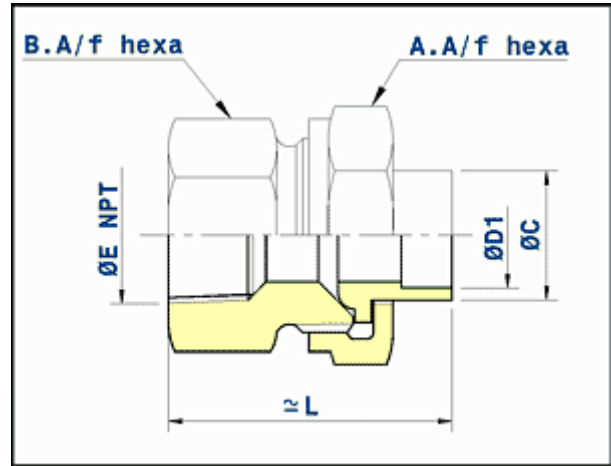

Outside diameter of pipe		ØE Thread (NPT)	ØC mm	L mm	A.A/f mm	B.A/f mm	Theoretical weight Kg/piece
nominal inch	ØD1 actual mm						
0.38	16	1/2"	23	50	42	27	0.25
0.5	20	1/2"	27	51	42	27	0.31
0.75	25	3/4"	32	56	50	32	0.43
1	30	1"	37	60	60	41	0.45
1.25	38	1" 1/4	45	68	70	50	0.72
1.5	44.5	1" 1/2	52	70	70	55	0.85
2	57	2"	64	76	85	70	1.35



COPPER NICKEL FORGED AND MACHINED FITTINGS

connectors in copper nickel

male union connector - butt welding ends x male thread

Printable version
PDF version

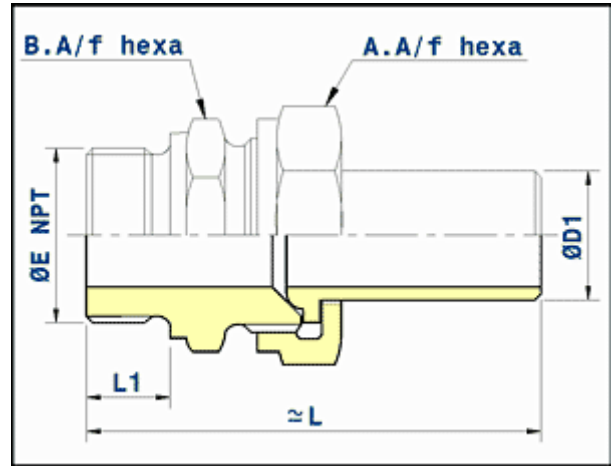

Outside diameter of pipe		ØE Thread (NPT)	L1 mm	L mm	A.A/f mm	B.A/f mm	Theoretical weight Kg/piece
nominal inch	ØD1 actual mm						
3/8"	16	3/4"	19	84	42	36	0.37
1/2"	20	3/4"	19	92	42	36	0.50
3/4"	25	1"	21	95	50	46	0.60
1"	30	1" 1/4	23	100	60	50	0.80
1" 1/4	38	1" 1/2	25	106	70	65	1.15
1" 1/2	44.5	1" 3/4	25.5	115	70	65	1.65
2"	57	2"	27.5	130	85	80	2.15



COPPER NICKEL FORGED AND MACHINED FITTINGS

connectors in copper nickel

male union connector - socket welding or capillary ends x male thread

Printable version
PDF version

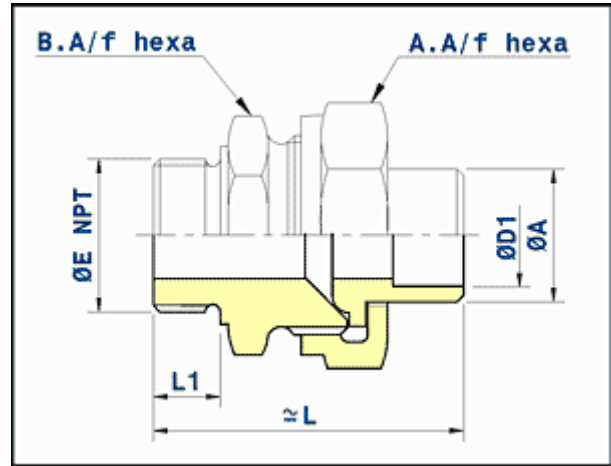

Outside diameter of pipe		ØE Thread (NPT)	ØA mm	L1 mm	L mm	A.A/f mm	B.A/f mm	Theoretical weight Kg/piece
nominal inch	ØD1 actual mm							
0.38	16	3/4"	23	19	74	42	36	0.35
0.5	20	3/4"	27	19	79	42	36	0.47
0.75	25	1"	32	21	82	50	46	0.55
1	30	1" 1/4	37	23	89	60	50	0.73
1.25	38	1" 1/2	45	25	97	70	65	1.05
1.5	44.5	1" 3/4	52	25.5	100	70	65	1.55
2	57	2"	64	27.5	109	85	80	2.00



COPPER NICKEL FORGED AND MACHINED FITTINGS

connectors in copper nickel

straight connector - socket welding or capillary ends x female thread

Printable version
PDF version

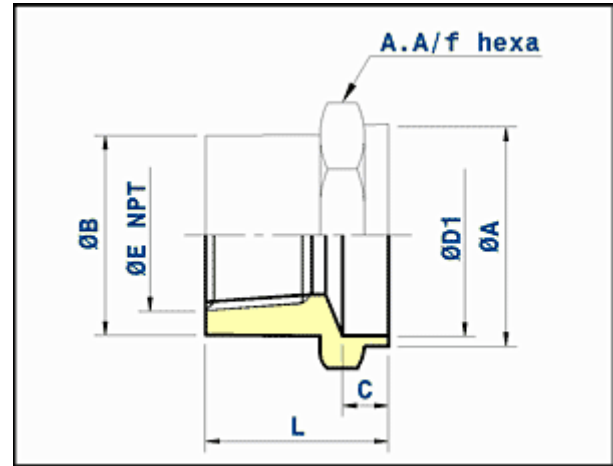

Outside diameter of pipe		ØE Thread (NPT)	ØA mm	C mm	ØB mm	L mm	A.A/f mm	Theoretical weight Kg/piece
nominal inch	ØD1 x ØE actual mm							
3/8" x 1/2"	16 x 20	1/2"	23	10	27	31	27	0.07
3/8" x 3/4"	16 x 25	3/4"	23	10	32	33	32	0.1
3/8" x 1"	16 x 30	1"	23	10	40	38	41	0.2
1/2" x 1/2"	20 x 20	1/2"	27	10	27	28	27	0.08
1/2" x 3/4"	20 x 25	3/4"	27	10	32	32	32	0.11
1/2" x 1"	20 x 30	1"	27	10	40	37	41	0.31
1/2" x 1" 1/4	20 x 38	1" 1/4	27	10	49	40	50	0.29
3/4" x 3/4"	25 x 25	3/4"	32	13	32	31	32	0.1
3/4" x 1"	25 x 30	1"	32	13	40	35	41	0.2
3/4" x 1" 1/4	25 x 38	1" 1/4	32	13	49	39	50	0.29
3/4" x 1" 1/2	25 x 44.5	1" 1/2	32	13	55	41	55	0.32
1" x 3/4"	30 x 25	3/4"	37	13	32	31	41	0.23
1" x 1"	30 x 30	1"	37	13	40	35	41	0.19
1" x 1" 1/4	30 x 38	1" 1/4	37	13	49	38	50	0.28
1" x 1" 1/2	30 x 44.5	1" 1/2	37	13	55	40	55	0.3
1" 1/4 x 3/4"	38 x 25	3/4"	45	13	32	39	41	0.39
1" 1/4 x 1"	38 x 30	1"	45	13	40	39	41	0.31
1" 1/4 x 1" 1/4	38 x 38	1" 1/4	45	13	49	40	50	0.29
1" 1/4 x 1" 1/2	38 x 44.5	1" 1/2	45	13	55	42	55	0.32
1" 1/2 x 1"	44.5 x 30	1"	52	13	40	43	55	0.55
1" 1/2 x 1" 1/4	44.5 x 38	1" 1/4	52	13	49	39	55	0.5
1" 1/2 x 1" 1/2	44.5 x 44.5	1" 1/2	52	13	55	40	55	0.43
1" 1/2 x 2"	44.5 x 57	2"	52	13	70	43	70	0.65
2" x 1" 1/4	57 x 38	1" 1/4	64	16	49	45	65	0.8
2" x 1" 1/2	57 x 44.5	1" 1/2	64	16	55	40	65	0.73
2" x 2"	57 x 57	2"	64	16	70	40	70	0.65
2" x 2" 1/2	57 x 76.1	2" 1/2	64	16	85	49	85	0.97



COPPER NICKEL FORGED AND MACHINED FITTINGS

connectors in copper nickel

straight connector - socket welding or capillary ends x male thread

Printable version
PDF version

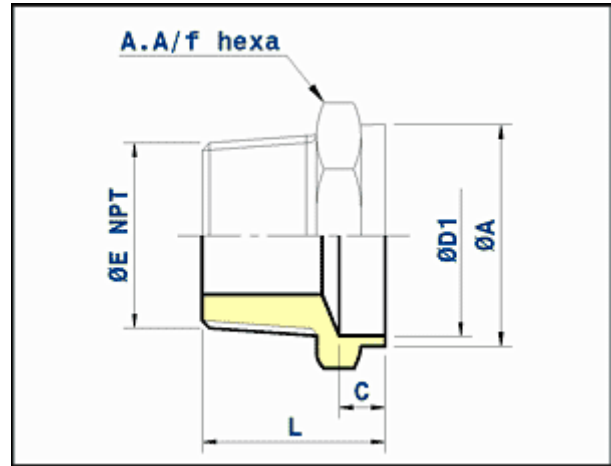

Outside diameter of pipe		ØE Thread (NPT)	ØA mm	C mm	L mm	A.A/f mm	Theoretical weight Kg/piece	
nominal inch	ØD1 x ØE actual mm							
0.38	x 0.5	16 x 20	1/2"	23	10	30	22	0.10
0.38	x 0.75	16 x 25	3/4"	23	10	33	30	0.13
0.38	x 1	16 x 30	1"	23	10	38	36	0.28
0.5	x 0.5	20 x 20	1/2"	27	10	33	27	0.11
0.5	x 0.75	20 x 25	3/4"	27	10	34	30	0.14
0.5	x 1	20 x 30	1"	27	10	39	36	0.25
0.5	x 1.25	20 x 38	1" 1/4	27	10	43	46	0.51
0.75	x 0.75	25 x 25	3/4"	32	13	35	32	0.15
0.75	x 1	25 x 30	1"	32	13	39	36	0.20
0.75	x 1.25	25 x 38	1" 1/4	32	13	43	46	0.46
0.75	x 1.5	25 x 44.5	1" 1/2	32	13	44	50	0.62
1	x 0.75	30 x 25	3/4"	37	13	38	41	0.24
1	x 1	30 x 30	1"	37	13	41	41	0.25
1	x 1.25	30 x 38	1" 1/4	37	13	44	46	0.39
1	x 1.5	30 x 44.5	1" 1/2	37	13	45	50	0.55
1.25	x 0.75	38 x 25	3/4"	45	13	44	46	0.30
1.25	x 1	38 x 30	1"	45	13	44	46	0.27
1.25	x 1.25	38 x 38	1" 1/4	45	13	45	46	0.32
1.25	x 1.5	38 x 44.5	1" 1/2	45	13	46	50	0.36
1.5	x 1	44.5 x 30	1"	52	13	47	55	0.40
1.5	x 1.25	44.5 x 38	1" 1/4	52	13	48	55	0.48
1.5	x 1.5	44.5 x 44.5	1" 1/2	52	13	48	55	0.48
1.5	x 2	44.5 x 57	2"	52	13	51	65	0.87
2	x 1.25	57 x 38	1" 1/4	64	16	51	65	0.68
2	x 1.5	57 x 44.5	1" 1/2	64	16	51	65	0.65
2	x 2	57 x 57	2"	64	16	51	65	0.57
2	x 2.5	57 x 76.1	2" 1/2	64	16	60	75	1.17



COPPER NICKEL FORGED AND MACHINED FITTINGS

connectors in copper nickel
union connector - butt welding ends

Printable version
PDF version

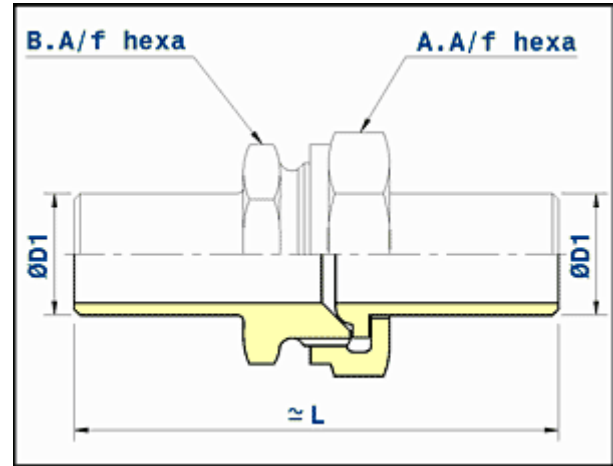

Outside diameter of pipe ØD		L mm	A.A/f mm	B.A/f mm	Theoretical weight Kg/piece
nominal inch	ØD1 actual mm				
0.38	16	95	42	36	0.35
0.5	20	99	42	36	0.45
0.75	25	101	50	46	0.59
1	30	105	60	50	0.88
1.25	38	110	70	65	1.15
1.5	44.5	113	70	65	1.54
2	57	120	85	80	2.30



COPPER NICKEL FORGED AND MACHINED FITTINGS

connectors in copper nickel

union connector - socket welding or capillary ends

Printable version
PDF version

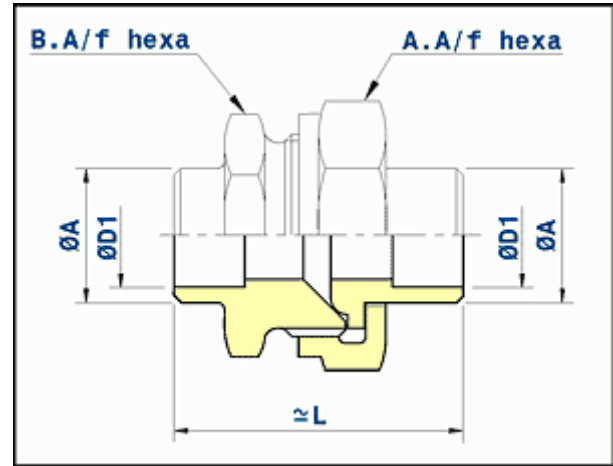

Outside diameter of pipe $\varnothing D$		$\varnothing A$ mm	L mm	A.A/f mm	B.A/f mm	Theoretical weight Kg/piece
nominal inch	$\varnothing D1$ actual mm					
0.38	16	23	62	42	36	0.24
0.5	20	27	62	42	36	0.31
0.75	25	32	73	50	46	0.44
1	30	37	73	60	50	0.55
1.25	38	45	79	70	65	0.73
1.5	44.5	52	84	70	65	1.08
2	57	64	94	85	80	1.54



CATALOG

copper nickel forged and machined fittings

couplets

Printable version

PDF version

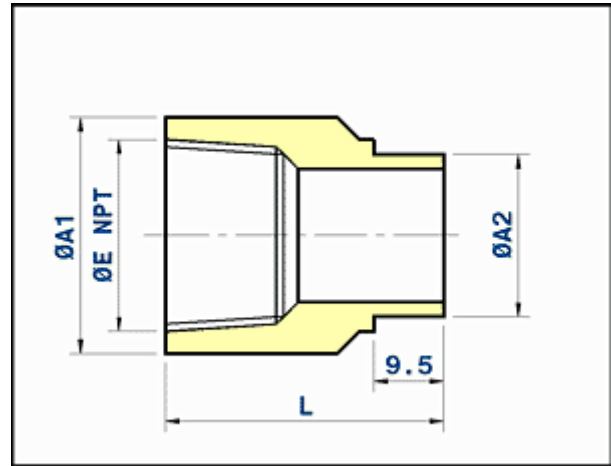

Outside diameter of pipe		ØE Thread (NPT)	ØA1 mm	ØA2 mm	L mm	Theoretical weight Kg/piece
nominal inch	actual mm					
1/4	12	1/4"	20	13.7	30	0.06
0.38	16	3/8"	22	17.1	30	0.11
0.5	20	1/2"	30	21.3	33.5	0.13
0.75	25	3/4"	35	26.7	35.5	0.21
1	30	1"	46	33.4	43	0.26
1.25	38	1" 1/4	57	42.2	47.5	0.34
1.5	44.5	1" 1/2	64	48.3	51	0.37
2	57	2"	76	60.3	57.5	0.41



COPPER NICKEL FORGED AND MACHINED FITTINGS

couplings in copper nickel

half coupling - threaded

Printable version
PDF version

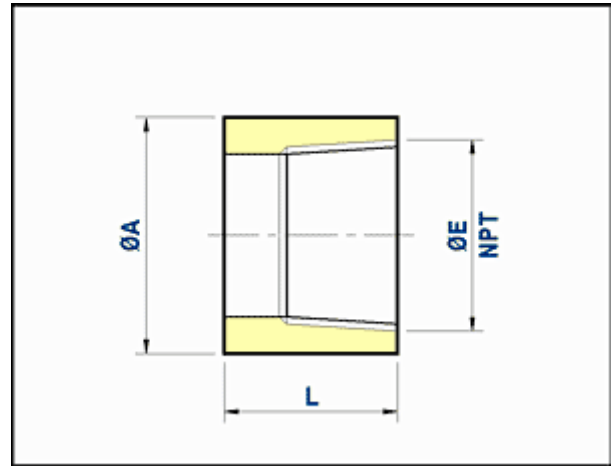

Outside diameter of pipe ØD		ØA mm	L mm	ØE Thread (NPT)	Theoretical weight Kg/piece
nominal inch	actual mm				
0.5	16	29	24.0	1/2"	0.08
0.75	25	35	25.5	3/4"	0.14
1	30	44	30.0	1"	0.19
1.25	38	57	33.5	1" 1/4	0.29
1.5	44.5	64	39.5	1" 1/2	0.39
2	57	76	43.0	2"	0.71



COPPER NICKEL FORGED AND MACHINED FITTINGS

couplings in copper nickel

half coupling - socket welding or capillary ends

Printable version
PDF version

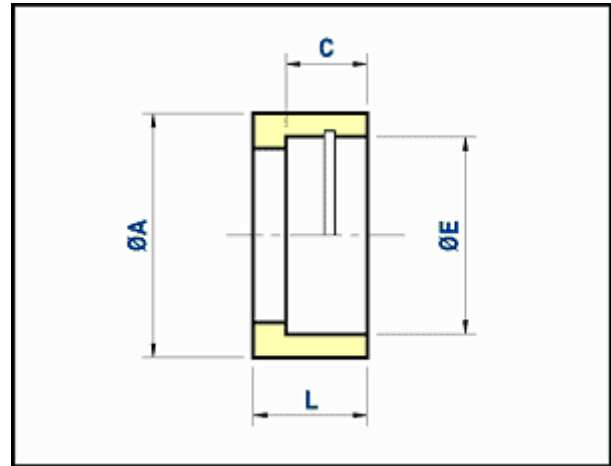

Outside diameter of pipe ØD		ØA mm	L mm	ØE mm	C mm	Theoretical weight Kg/piece
nominal inch	actual mm					
0.38	16	23	13	16.1	10	0.02
0.5	20	27	13	20.1	10	0.03
0.75	25	32	17	25.1	13	0.04
1	30	37	17	30.1	13	0.05
1.25	38	45	17	38.1	13	0.06
1.5	44.5	52	18	44.6	13	0.08
2	57	64	22	57.3	16	0.11



COPPER NICKEL FORGED AND MACHINED FITTINGS

couplings in copper nickel

reducing coupling - socket welding or capillary ends

Printable version
PDF version

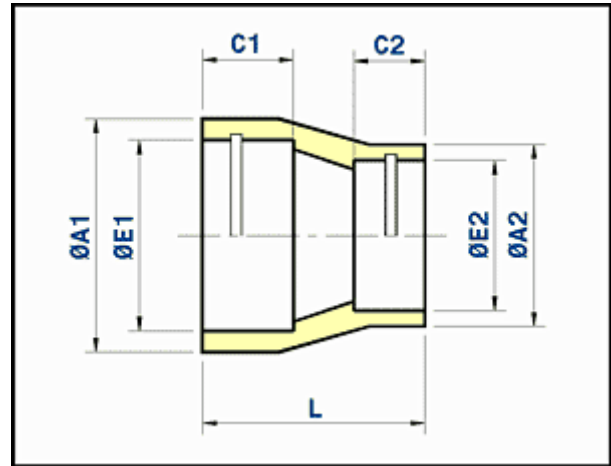

Outside diameter of pipe ØD		ØA1 mm	ØE1 mm	C1 mm	ØA2 mm	ØE2 mm	C2 mm	L mm	Theoretical weight Kg/piece		
nominal inch	actual mm										
0.5	x 0.125	20	x 16	27	20.1	10	23	16.1	10	27	0.07
0.75	x 0.125	25	x 16	32	25.1	13	23	16.1	10	33	0.07
0.75	x 0.5	25	x 20	32	25.1	13	27	20.1	10	27	0.08
1	x 0.125	30	x 16	37	30.1	13	23	16.1	10	35	0.09
1	x 0.5	30	x 20	37	30.1	13	27	20.1	10	31	0.08
1	x 0.75	30	x 25	37	30.1	13	32	25.1	13	28	0.08
1.25	x 0.125	38	x 16	45	38.1	13	23	16.1	10	45	0.18
1.25	x 0.5	38	x 20	45	38.1	13	27	20.1	10	41	0.17
1.25	x 0.75	38	x 25	45	38.1	13	32	25.1	13	36	0.16
1.25	x 1	38	x 30	45	38.1	13	37	30.1	13	33	0.15
1.5	x 0.125	44.5	x 16	52	44.6	13	23	16.1	10	51	0.20
1.5	x 0.5	44.5	x 20	52	44.6	13	27	20.1	10	47	0.21
1.5	x 0.75	44.5	x 25	52	44.6	13	32	25.1	13	42	0.22
1.5	x 1	44.5	x 30	52	44.6	13	37	30.1	13	39	0.23
1.5	x 1.25	44.5	x 38	52	44.6	13	45	38.1	13	36	0.24
2	x 0.125	57	x 16	64	57.3	16	23	16.1	10	62	0.28
2	x 0.5	57	x 20	64	57.3	16	27	20.1	10	58	0.27
2	x 0.75	57	x 25	64	57.3	16	32	25.1	13	54	0.26
2	x 1	57	x 30	64	57.3	16	37	30.1	13	50	0.25
2	x 1.25	57	x 38	64	57.3	16	45	38.1	13	47	0.24
2	x 1.5	57	x 44.5	64	57.3	16	52	44.6	13	41	0.23



COPPER NICKEL FORGED AND MACHINED FITTINGS

couplings in copper nickel
 straight coupling - threaded

Printable version
 PDF version

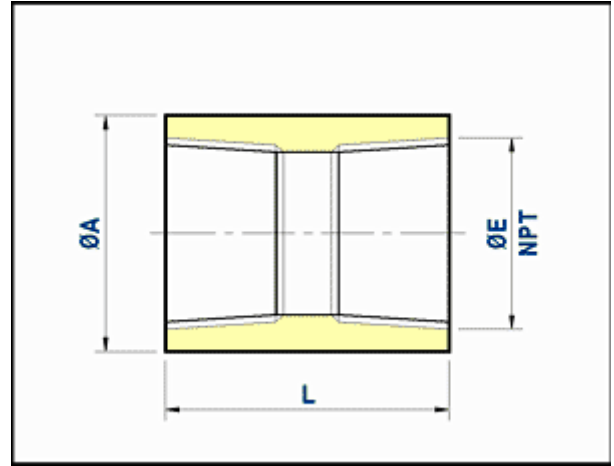

Outside diameter of pipe ØD		ØA mm	L mm	ØE Thread (NPT)	Theoretical weight Kg/piece
nominal inch	actual mm				
0.5	16	29	48	1/2"	0.16
0.75	25	35	51	3/4"	0.28
1	30	44	60	1"	0.38
1.25	38	57	67	1" 1/4	0.58
1.5	44.5	64	79	1" 1/2	0.78
2	57	76	86	2"	1.42



COPPER NICKEL FORGED AND MACHINED FITTINGS

couplings in copper nickel

straight coupling - socket welding or capillary ends

Printable version
PDF version

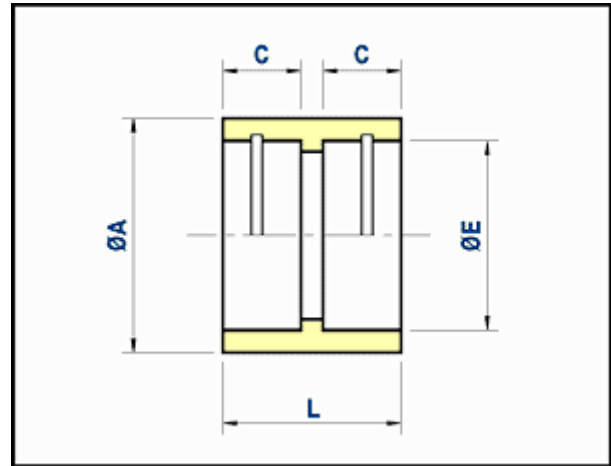

Outside diameter of pipe ØD		ØA mm	L mm	ØE mm	C mm	Theoretical weight Kg/piece
nominal inch	actual mm					
0.38	16	23	23	16.1	10	0.04
0.5	20	27	23	20.1	10	0.06
0.75	25	32	30	25.1	13	0.08
1	30	37	30	30.1	13	0.10
1.25	38	45	30	38.1	13	0.12
1.5	44.5	52	31	44.6	13	0.17
2	57	64	38	57.3	16	0.22



COPPER NICKEL FORGED AND MACHINED FITTINGS

end caps in copper nickel

female threaded

Printable version
PDF version

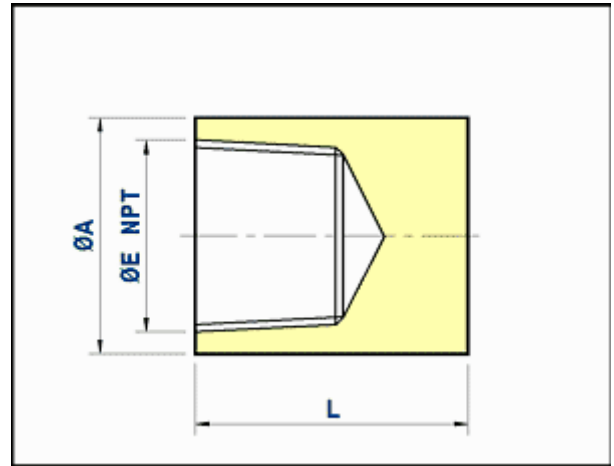

Outside diameter of pipe		ØE Thread (NPT)	ØA mm	L mm	Theoretical weight Kg/piece
nominal inch	actual mm				
0.5	16	1/2"	29	32	0.17
0.75	25	3/4"	35	37	0.30
1	30	1"	44	38	0.55
1.25	38	1" 1/4	57	41	0.95
1.5	44.5	1" 1/2	64	41	1.10
2	57	2"	76	42	1.85



COPPER NICKEL FORGED AND MACHINED FITTINGS

end caps in copper nickel
socket welding or capillary ends

Printable version
PDF version

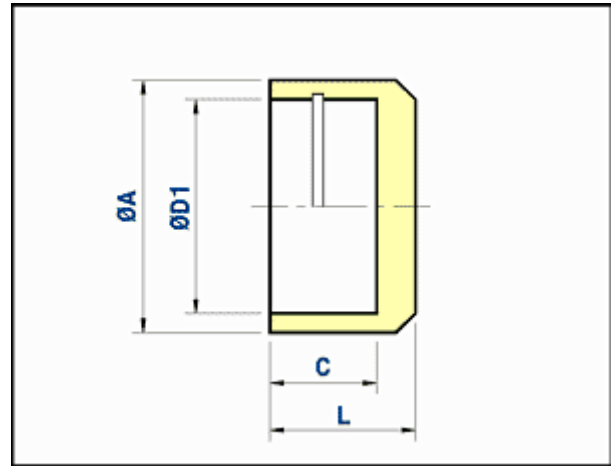

Outside diameter of pipe		ØA mm	L mm	C mm	Theoretical weight Kg/piece
nominal inch	actual mm				
0.38	16	23	14.0	10	0.04
0.5	20	27	14.5	10	0.05
0.75	25	32	15.0	13	0.07
1	30	37	16.0	13	0.08
1.25	38	45	20.0	13	0.13
1.5	44.5	52	20.5	13	0.19
2	57	64	20.5	16	0.22



COPPER NICKEL FORGED AND MACHINED FITTINGS

forged elbows in copper nickel
socket welding or capillary ends

45°

Printable version
PDF version

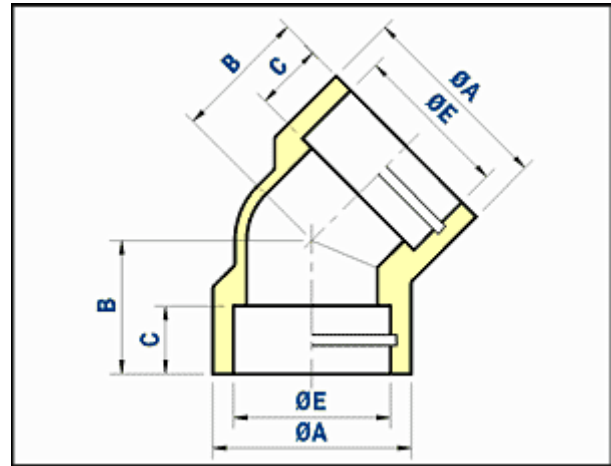

Outside diameter of pipe ØD		ØA mm	B mm	C mm	ØE mm	Theoretical weight Kg/piece
nominal inch	actual mm					
0.38	16	22.20	19.0	10	16.1	0.07
0.5	20	26.05	19.0	10	20.1	0.10
0.75	25	33.00	22.5	13	25.1	0.26
1	30	38.00	25.5	13	30.1	0.41
1.25	38	46.00	28.5	13	38.1	0.64
1.5	44.5	56.00	33.0	13	44.6	0.69
2	57	63.50	36.0	16	57.3	1.09



COPPER NICKEL FORGED AND MACHINED FITTINGS

forged elbows in copper nickel
socket welding or capillary ends

90°

Printable version
PDF version

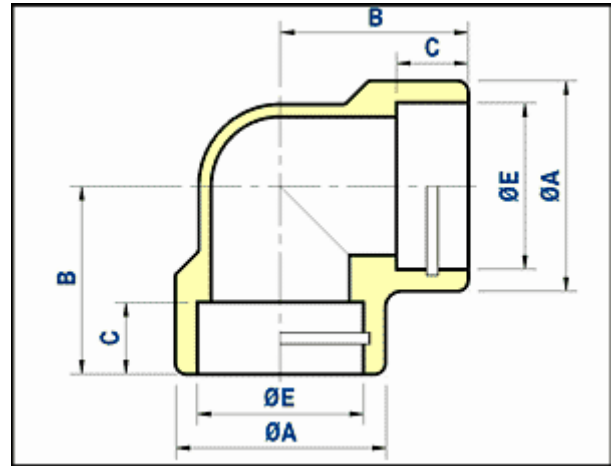

Outside diameter of pipe ØD		ØA mm	B mm	C mm	ØE mm	Theoretical weight Kg/piece
nominal inch	actual mm					
0.38	16	22.20	20	10	16.1	0.07
0.5	20	26.05	25	10	20.1	0.10
0.75	25	33.00	29	13	25.1	0.26
1	30	38.00	34	13	30.1	0.32
1.25	38	46.00	38	13	38.1	0.59
1.5	44.5	56.00	44	13	44.6	1.01
2	57	63.50	50	16	57.3	1.31



SITINDUSTRIE MARINE

> MARINE

- Catalog
- Request For Quotation
- 5 Factories
- Quality
- References
- Major projects
- Applications
- Installation instructions

> ABOUT US

- [About Sitindustrie Marine SAS](#)
- [Sitindustrie Group](#)
- [Agents & Distributors network](#)
- [Contact us](#)

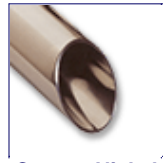

Copper Nickel Pipes



Copper Nickel Bars



Copper Nickel Butt Weld Fittings



Copper Nickel Flanges



Copper Nickel Forged And Machined Fittings

Forged Elbows In Copper Nickel
Socket Welding Or Capillary Ends
Forged Tees In Copper Nickel
 Socket welding or capillary ends equal
 Reducing tees
 socket welding or capillary ends

Couplings In Copper Nickel
Reducing Inserts In Copper Nickel
Connectors In Copper Nickel
Adaptors In Copper Nickel
Sprinkler Bushes In Copper Nickel
Male Plugs In Copper Nickel
End Caps In Copper Nickel
Nipples In Copper Nickel
Bosses In Copper Nickel
Couplets
Sockets Form B In Copper Nickel
Sockets Form C In Copper Nickel
Olets In Copper Nickel

>> Request For Quotation : [Click Here](#)

SITINDUSTRIE MARINE : COPPER NICKEL PIPES AND FITTINGS PACKAGES FOR SHIPBUILDING AND OFFSHORE INDUSTRIES



"Sitindustrie Marine", based in Marseille, has been created to promote and distribute for the worldwide shipbuilding and offshore industries copper nickel pipes and fittings, recognized as the best compromise for seawater corrosion resistant line pipes material. Sitindustrie Marine offers:

- **A single manufacturing source** able to offer a complete range of copper nickel pipes and fittings produced within different factories of the group in

> MARKET INDEX

Date	09/10/2007
Copper (LME)	7,991.00 USD/t
Nickel (LME)	30,260.00 USD/t
Copper Nickel 90/10	10,217.90 USD/t
Copper Nickel 70/30	14,671.70 USD/t
EUR/USD	1.4037

> News

>> 12/07

ORDER OF 16 MILLION EURO FOR THE RETUBING OF THE MOST IMPORTANT COAL-FIRED POWER STATION IN EUROPE [more details]

>> 03/07

SITINDUSTRIE MARINE: FIRST MAJOR SUCCESS IN BRAZIL! [more details]

- accordance with all international standards.
- **A customized service** with high flexibility, deliveries directly from our production plants for large quantity requirements or from our stock for fast track projects.
 - **A team of specialists at your service**, with more than 10 years experience in the copper nickel industry, who will help you to define the best technical and economical solutions, and will ensure their successful implementation.
 - **An international network of agents and distributors** dedicated to customer satisfaction that will provide you with a full project follow-up from budget and inquiry stage to on site deliveries and installation.

Sitindustrie's plants are ISO 9002:2000 approved and homologated by the most important international organizations: RINA, TUV, BUREAU VERITAS, LLOYDS REGISTER, DNV etc...

[Catalog](#) | [Request For Quotation](#) | [Quality](#) | [References](#) | [Applications](#) | [Installation instructions](#)
[About Sitindustrie Marine SAS](#) | [Agents & Distributors network](#) | [Contact us](#)

[Home](#) - [Back to top](#) - [Contact us](#)

Copyright © 2004 - 2006 Sitindustrie Marine S.A.S.



COPPER NICKEL FORGED AND MACHINED FITTINGS

forged tees in copper nickel

Socket welding or capillary ends
equal

Printable version
PDF version

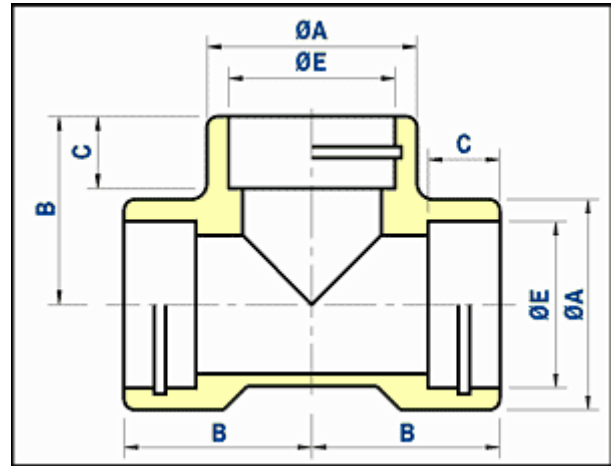

Outside diameter of pipe ØD		ØA mm	B mm	ØE mm	C mm	Theoretical weight Kg/piece
nominal inch	actual mm					
0.38	16	22.20	20	16.1	10	0.09
0.5	20	26.05	25	20.1	10	0.12
0.75	25	33.00	29	25.1	13	0.31
1	30	38.00	34	30.1	13	0.37
1.25	38	46.00	38	38.1	13	0.65
1.5	44.5	56.00	44	44.6	13	1.08
2	57	63.50	50	57.3	16	1.43



CATALOG

copper nickel forged and machined fittings

male plugs in copper nickel

Printable version
PDF version

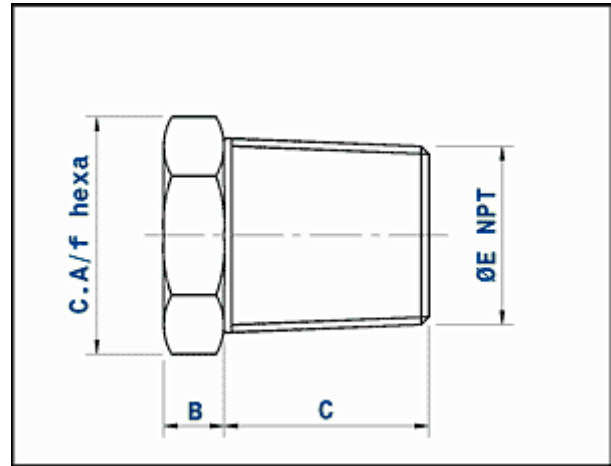

Outside diameter of pipe		ØE Thread (NPT)	B mm	C mm	C.A/f mm	Theoretical weight Kg/piece
nominal inch	actual mm					
1/2"	16	1/2"	8	18	19	0.17
3/4"	25	3/4"	10	18	24	0.30
1"	30	1"	10	21	30	0.55
1" 1/4	38	1" 1/4	14	22	41	0.95
1" 1/2	44.5	1" 1/2	16	22	41	1.10
2"	57	2"	17	22	50	1.85



COPPER NICKEL FORGED AND MACHINED FITTINGS

nipples in copper nickel
hexagonal

Printable version
PDF version

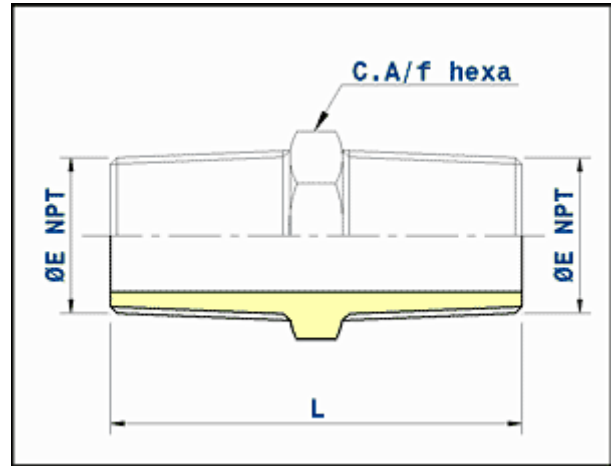

Outside diameter of pipe		ØE Thread (NPT)	L mm	C.A/f mm	Theoretical weight Kg/piece
nominal inch	actual mm				
1/4	12	1/4"	42	17	0.05
0.38	16	3/8"	47	22	0.11
0.5	20	1/2"	48	24	0.13
0.75	25	3/4"	52	30	0.20
1	30	1"	60	36	0.29
1.25	38	1" 1/4	72	46	0.36
1.5	44.5	1" 1/2	74	50	0.43
2	57	2"	78	65	0.59



COPPER NICKEL FORGED AND MACHINED FITTINGS

nipples in copper nickel
pipe

Printable version
PDF version

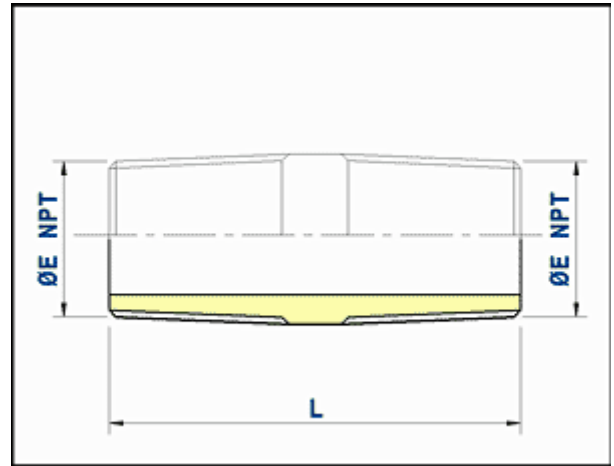

Outside diameter of pipe		ØE Thread (NPT)	L mm	Theoretical weight Kg/piece
nominal inch	actual mm			
1/4	12	1/4"	42	0.04
0.38	16	3/8"	47	0.10
0.5	20	1/2"	48	0.12
0.75	25	3/4"	52	0.19
1	30	1"	60	0.28
1.25	38	1" 1/4	72	0.35
1.5	44.5	1" 1/2	74	0.42
2	57	2"	78	0.58



COPPER NICKEL FORGED AND MACHINED FITTINGS

olet in copper nickel

sockolets

Printable version

PDF version

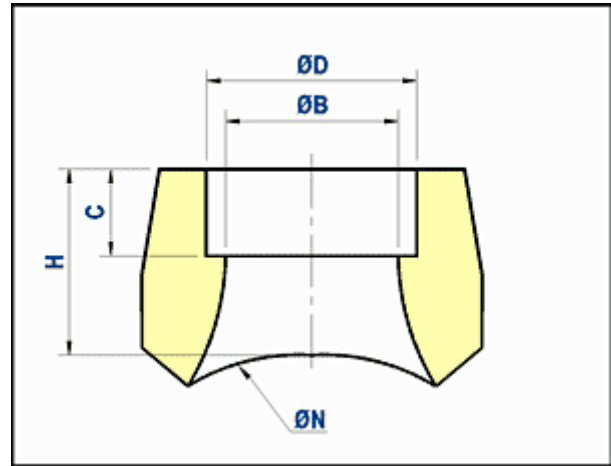

Outside diameter of branch pipe ØD		Outside diameter of header ØN		ØB mm	H mm	C mm	Theoretical weight Kg/piece
nominal inch	actual mm	nominal inch	actual mm				
0.5	16	0.75 to 1.5	25 to 44.5	12.0	25.4	10	0.10
0.5	16	2 to 36	57 to 914	12.0	23.8	10	0.10
0.75	25	1 to 1.5	30 to 44.5	21.0	26.9	13	0.13
0.75	25	2 to 36	57 to 914	21.0	25.4	13	0.13
1	30	1.25 to 1.5	38 to 44.5	25.0	33.3	13	0.22
1	30	2 to 36	57 to 914	25.0	28.6	13	0.22
1.25	38	2 to 36	57 to 914	33.0	33.3	13	0.35
1.25	38	2 to 36	57 to 914	33.0	33.3	13	0.35
1.5	44.5	2 to 36	57 to 914	39.5	30.2	13	0.50
1.5	44.5	2 to 36	57 to 914	39.5	30.2	13	0.50
2	57	2.5 to 36	76.1 to 914	52.0	38.1	16	0.90
2	57	2.5 to 36	76.1 to 914	52.0	38.1	16	0.90



COPPER NICKEL FORGED AND MACHINED FITTINGS

olelets in copper nickel
threadolelets

Printable version
PDF version

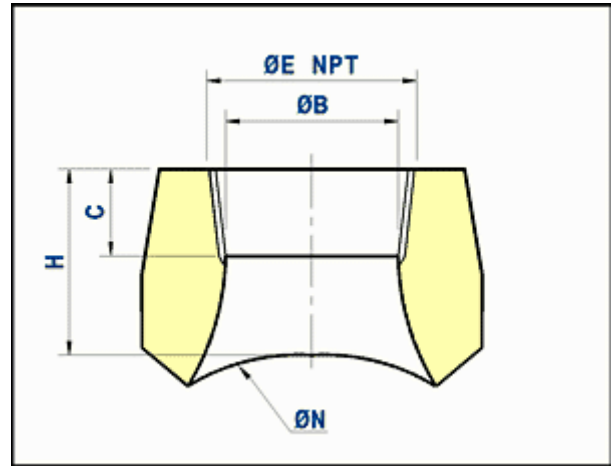

Outside diameter of branch pipe ØD		Outside diameter of header ØA		ØB (bore) mm	H mm	C mm	Theoretical weight Kg/piece
nominal inch	actual (NPT)	nominal inch	actual mm				
1/2"	1/2"	3/4" to 1" 1/2	25 to 44.5	11.74	25.4	13.5	0.10
1/2"	1/2"	2" to 36"	57 to 914	11.74	23.8	13.5	0.10
3/4"	3/4"	1" to 1" 1/2	30 to 44.5	15.58	26.9	14	0.13
3/4"	3/4"	2" to 36"	57 to 914	15.58	25.4	14	0.13
1"	1"	1" 1/4 to 1" 1/2	38 to 44.5	20.70	33.3	17.5	0.22
1"	1"	2" to 36"	57 to 914	20.70	28.6	17.5	0.22
1" 1/4	1" 1/4	2" to 36"	57 to 914	29.50	33.3	18	0.35
1" 1/4	1" 1/4	2" to 36"	57 to 914	29.50	33.3	18	0.35
1" 1/2	1" 1/2	2" to 36"	57 to 914	34.02	30.2	18.5	0.50
1" 1/2	1" 1/2	2" to 36"	57 to 914	34.02	30.2	18.5	0.50
2"	2"	2" 1/2 to 36"	76.1 to 914	42.82	38.1	19	0.90
2"	2"	2" 1/2 to 36"	76.1 to 914	42.82	38.1	19	0.90



COPPER NICKEL FORGED AND MACHINED FITTINGS

olelets in copper nickel

weldolets

Printable version

PDF version

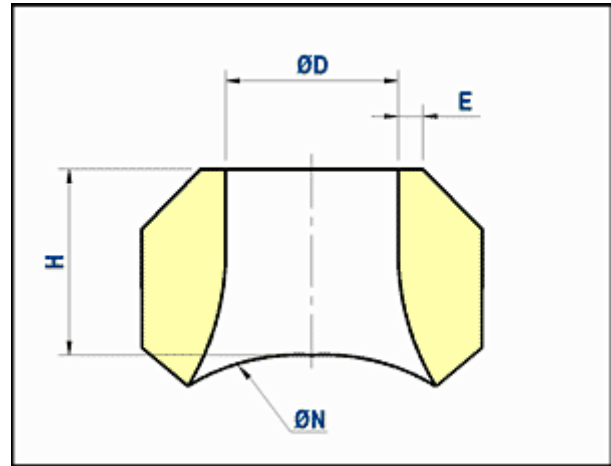

Outside diameter of branch pipe ØD		Outside diameter of header ØN		E		H	Theoretical weight Kg/piece
nominal inch	actual mm	nominal inch	actual mm	16 Bar mm	20 Bar mm	mm	
0.5	16	0.5 to 1.5	16 to 44.5	2	2	19.05	0.07
0.5	16	2 to 24	57 to 610	2	2	17.50	0.07
0.75	25	0.75 to 1.5	25 to 44.5	2	2	22.20	0.11
0.75	25	2 to 24	57 to 610	2	2	20.60	0.11
1	30	1 to 1.5	30 to 44.5	2.5	2.5	27.00	0.18
1	30	2 to 24	57 to 610	2.5	2.5	22.20	0.18
1.25	38	1.25 to 1.5	38 to 44.5	2.5	2.5	30.20	0.32
1.25	38	2 to 24	57 to 610	2.5	2.5	25.40	0.32
1.5	44.5	1.5	44.5	2.5	2.5	33.30	0.36
1.5	44.5	2 to 24	57 to 610	2.5	2.5	28.60	0.36
2	57	2 to 2.5	57 to 76.1	2.5	2.5	38.10	0.68
2	57	3 to 24	88.9 to 610	2.5	2.5	33.30	0.68
2.5	76.1	3 to 4	76.1 to 108	2.5	2.5	47.60	1.4
2.5	76.1	6 to 24	159 to 610	2.5	2.5	44.50	1.4
3	88.9	3 to 4	88.9 to 108	2.5	2.5	47.60	1.7
3	88.9	6 to 24	159 to 610	2.5	2.5	44.50	1.7
4	108	4	108	3	3	46.80	3
4	108	6	159	3	3	52.4	3
4	108	8 to 24	219.1 to 610	3	3	49.2	6.4
6	159	6 to 24	159 to 610	3	3.5	60.30	6.4
8	219.1	8 to 24	219.1 to 610	4	4.5	69.90	12.7
10	267	10 to 24	267 to 610	4.5	5.5	77.80	17.7
12	323.9	12 to 24	323.9 to 610	5.5	7	85.70	29.5
14	368	14 to 24	368 to 610	6.5	8	88.90	31.8
16	419.1	16 to 24	419.1 to 610	7	9	93.70	41.7
18	457.2	18 to 24	457.2 to 610	8	9.5	96.80	53.2
20	508	20 to 24	508 to 610	8.5	11	115.90	68.3
24	610	24	610	11/2	13	115.9	91.2



COPPER NICKEL FORGED AND MACHINED FITTINGS

reducing inserts in copper nickel

capillary x male ends

Printable version
PDF version

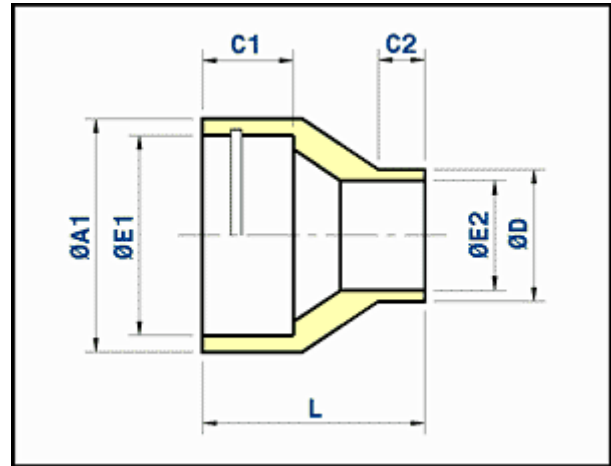

Outside diameter of pipe ØD		ØA1 mm	ØE1 mm	C1 mm	ØD (OD) mm	ØE2 mm	C2 mm	L mm	Theoretical weight Kg/piece		
nominal inch	actual mm										
0.5	x 0.38	20	x 16	27	20.1	10	16	14	12	29	0.03
0.75	x 0.38	25	x 16	32	25.1	13	16	14	12	31	0.04
0.75	x 0.5	25	x 20	32	25.1	13	20	18	12	29	0.04
1	x 0.38	30	x 16	37	30.1	13	16	14	12	35	0.05
1	x 0.5	30	x 20	37	30.1	13	20	18	12	33	0.05
1	x 0.75	30	x 25	37	30.1	13	25	22	12	30	0.06
1.25	x 0.38	38	x 16	45	38.1	13	16	14	12	43	0.06
1.25	x 0.5	38	x 20	45	38.1	13	20	18	12	41	0.07
1.25	x 0.75	38	x 25	45	38.1	13	25	22	12	38	0.07
1.25	x 1	38	x 30	45	38.1	13	30	27	13	37	0.09
1.5	x 0.5	44.5	x 20	52	44.6	13	20	18	12	44	0.10
1.5	x 0.75	44.5	x 25	52	44.6	13	25	22	12	42	0.12
1.5	x 1	44.5	x 30	52	44.6	13	30	27	13	41	0.13
1.5	x 1.25	44.5	x 38	52	44.6	13	38	35	17	41	0.14
2	x 0.75	57	x 25	64	57.3	16	25	22	12	49	0.14
2	x 1	57	x 30	64	57.3	16	30	27	13	48	0.19
2	x 1.25	57	x 38	64	57.3	16	38	35	17	48	0.21
2	x 1.5	57	x 44.5	64	57.3	16	44.5	41.5	17	44	0.23



COPPER NICKEL FORGED AND MACHINED FITTINGS

reducing inserts in copper nickel

male x capillary ends

Printable version
PDF version

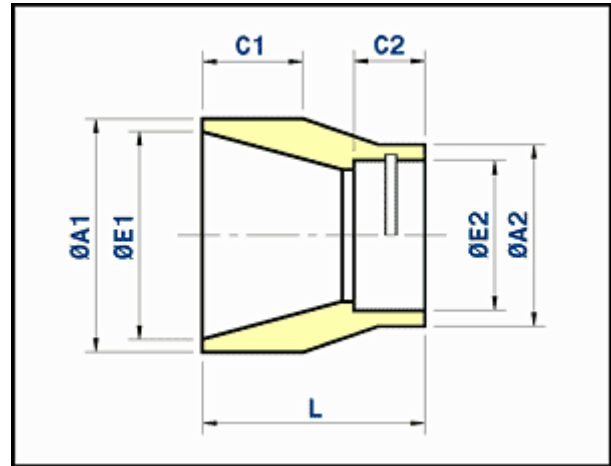

Outside diameter of pipe ØD		ØA1 mm	ØE1 mm	C1 mm	ØA2 mm	ØE2 mm	C2 mm	L mm	Theoretical weight Kg/piece		
nominal inch	actual mm										
0.5	x 0.38	20	x 16	20	18	12	23	16.1	10	23	0.03
0.75	x 0.38	25	x 16	25	22	12	23	16.1	10	23	0.05
0.75	x 0.5	25	x 20	25	22	12	27	20.1	10	23	0.04
1	x 0.38	30	x 16	30	27	13	22	16.1	10	30	0.06
1	x 0.5	30	x 20	30	27	13	27	20.1	10	24	0.06
1	x 0.75	30	x 25	30	27	13	32	25.1	13	24	0.06
1.25	x 0.38	38	x 16	38	35	17	23	16.1	10	41	0.12
1.25	x 0.5	38	x 20	38	35	17	27	20.1	10	36	0.12
1.25	x 0.75	38	x 25	38	35	17	32	25.1	13	32	0.12
1.25	x 1	38	x 30	38	35	17	37	30.1	13	30	0.10
1.5	x 0.38	44.5	x 16	44.5	41.5	17	23	16.1	10	43	0.18
1.5	x 0.5	44.5	x 20	44.5	41.5	17	27	20.1	10	42	0.18
1.5	x 0.75	44.5	x 25	44.5	41.5	17	32	25.1	13	38	0.16
1.5	x 1	44.5	x 30	44.5	41.5	17	37	30.1	13	34	0.15
1.5	x 1.25	44.5	x 38	44.5	41.5	17	45	38.1	13	34	0.11
2	x 0.38	57	x 16	57	54	17	23	16.1	10	52	0.30
2	x 0.5	57	x 20	57	54	17	27	20.1	10	43	0.31
2	x 0.75	57	x 25	57	54	17	32	25.1	13	45	0.31
2	x 1	57	x 30	57	54	17	37	30.1	13	45	0.32
2	x 1.25	57	x 38	57	54	17	45	38.1	13	42	0.28
2	x 1.5	57	x 44.5	57	54	17	52	44.6	13	36	0.26



CATALOG

copper nickel forged and machined fittings

sockets form B in copper nickel

Printable version

PDF version

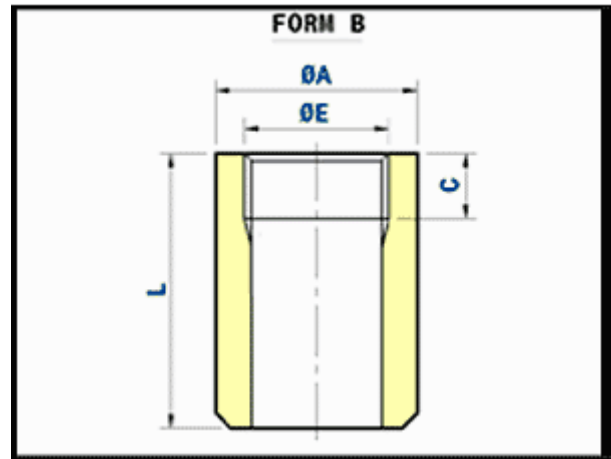

ØD Thread (NPT)	FORM B				Theoretical weight Kg/piece
	ØA mm	C mm	L mm		
R 1/4"	20	12	20	0.03	
R 3/8"	25	12	20	0.05	
R 1/2"	30	14	23	0.08	
R 1/2"	30	14	50	0.17	
R 1/2"	30	14	75	0.25	
R 1/2"	30	14	100	0.34	
R 1/2"	30	14	125	0.44	
R 3/4"	38	16	25	0.14	
R 3/4"	38	16	50	0.28	
R 3/4"	38	16	75	0.42	
R 3/4"	38	16	100	0.56	
R 3/4"	38	16	125	0.70	
R 1"	45	18	28	0.19	
R 1"	45	18	50	0.35	
R 1"	45	18	75	0.52	
R 1"	45	18	100	0.70	
R 1"	45	18	125	0.88	
R 1" 1/4	55	20	30	0.29	
R 1" 1/2	60	22	32	0.37	
R 2"	75	23	40	0.68	



CATALOG

copper nickel forged and machined fittings
 sockets form C in copper nickel

Printable version
 PDF version

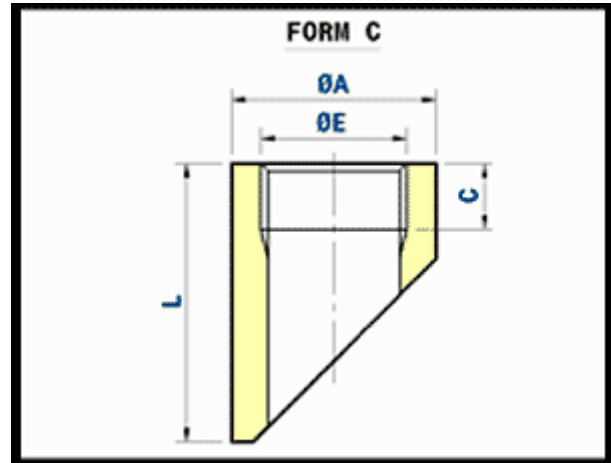

ØD Thread (NPT)	FORM C			
	ØA mm	C mm	L mm	Theoretical weight Kg/piece
R 1/2"	30	14	50	0.14
R 3/4"	38	16	60	0.24
R 1"	45	18	70	0.35
R 1" 1/4	55	20	80	0.63
R 1" 1/2	62	22	100	0.92
R 2"	75	23	111	1.25



CATALOG

copper nickel forged and machined fittings
 sprinkler bushes in copper nickel

Printable version
 PDF version

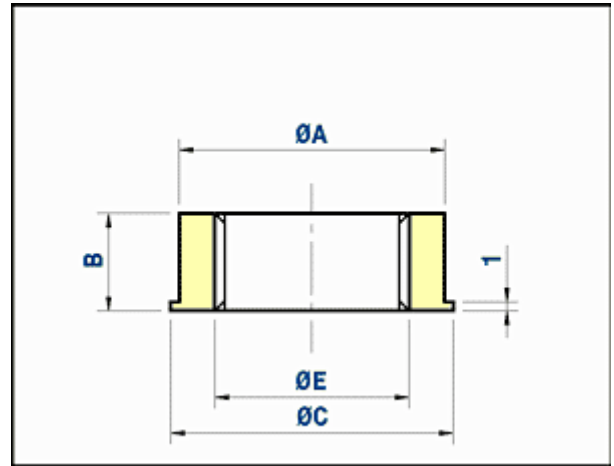

Outside diameter of pipe		$\varnothing E$ Thread	$\varnothing A$ mm	$\varnothing C$ mm	B mm	Theoretical weight Kg/piece
nominal inch	actual mm					
0.38	16		16	18	11	0.01
0.5	20		20	22	11	0.01
0.75	25		25	27	11	0.02
1	30		30	32	12	0.03
1.25	38		38	40	16	0.06
1.5	44.5		44.5	47	16	0.08
2	57		57	59	16	0.09